

Drain: VILLAGE OF WEST CLAY DRAIN **Drain #:** 312
Improvement/Arm: SECTION 3001
Operator: JDH **Date:** 6-29-04
Drain Classification: Urban/Rural **Year Installed:** 1999

GIS Drain Input Checklist

- Pull Source Documents for Scanning JDH
- Digitize & Attribute Tile Drains N/A
- Digitize & Attribute Storm Drains JDH
- Digitize & Attribute SSD N/A
- Digitize & Attribute Open Ditch N/A
- Stamp Plans JDH
- Sum drain lengths & Validate JDH
- Enter Improvements into Posse JDH
- Enter Drain Age into Posse _____
- Sum drain length for Watershed in Posse _____
- Check Database entries for errors JDH

Gasb 34 Footages for Historical Cost Drain Length Log

Drain-Improvement: VILLAGE OF WEST CLAY - SECTION 2001

Drain Type:	Size:	Length <i>swimming resort</i>	Length (DB Query)	Length Reconcile	If Applicable	
					Price:	Cost:
RCP	12"	1132'	1132'	Ø		
	15"	130'	130'	Ø		
	18"	294'	294'	Ø		
	21"	729'	729'	Ø		
	27"	118'	118'	Ø		
	30"	650'	650'	Ø		
	33"	299'	299'	Ø		
	36"	403'	403'	Ø		
	48"	414'	414'	Ø		

Sum: 4169' 4169' Ø _____

Final Report: _____

Comments:

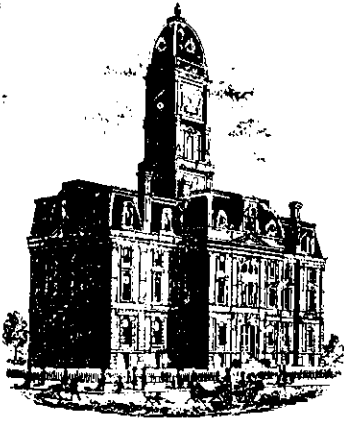

SURVEYOR'S OFFICE

Hamilton County

Kenton C. Ward, Surveyor

Phone (317) 776-8495

Fax (317) 776-9628

Suite 146

One Hamilton County Square

Noblesville, Indiana 46060-2230

To: Hamilton County Drainage Board

August 2, 1999

Re: Village of West Clay, Section 3001 Arm

Attached is a petition, non-enforcement request, plans, calculations, quantity summary and assessment roll for the Section 3001 Arm, Village of West Clay Drain. I have reviewed the submittals and petition and have found each to be in proper form.

I have made a personal inspection of the land described in the petition. Upon doing so, I believe that the drain is practicable; will improve public health; benefit a public highway and be of public utility; and that the costs, damages and expenses of the proposed drain will probably be less than the benefits accruing to the owners of land likely to be benefited. The drain will consist of the following:

12" RCP	1,061 ft	21" RCP	247 ft	30" RCP	615 ft.
15" RCP	166 ft	24" RCP	433 ft	33" RCP	371 ft
18" RCP	322 ft	27" RCP	117 ft	36" RCP	829 ft

The total length of the drain will be 4,161 feet.

The retention pond located in Block F, Tree Shadow Pond is not to be considered part of the regulated drain. Only the inlet and outlet will be maintained as part of the regulated drain. The maintenance of the pond will be the responsibility of the Homeowners Association. The Board will however, retain jurisdiction for ensuring the storage volume for which the lake was designed will be retained. Thereby, allowing no fill or easement encroachments.

The subsurface drains (SSD) under curbs are not to be part of the regulated drain. This is per an agreement between Brenwick Development and the Hamilton County Commissioners

meeting on April 26, 1999. (See Commissioners Minute Book 93, pages 565 - 566).

I have reviewed the plans and believe the drain will benefit each lot equally. Therefore, I recommend each lot be assessed equally. I also believe that no damages will result to landowners by the construction of this drain. I recommend a maintenance assessment of \$5.00 per acre, \$5.00 per acre for roadways, with a \$120.00 minimum. With this assessment the total annual assessment for this drain/this location will be \$6,346.10.

Parcels assessed for this drain may be assessed for the Collins-Osborn or Williams Creek Drains at sometime in the future. Parcels assessed for these drains will also be assessed for the Elliot Creek Drain.

I believe this proposed drain meets the requirements for Urban Drain Classification as set out in IC 36-9-27-67 - 69. Therefore, this drain shall be designated as an Urban Drain.

I recommend that upon approval of the above proposed drain that the Board also approve the attached non-enforcement request. This request is for the reduction of the regulated drain easement to those easement widths as shown on the secondary plat for Village of West Clay, Section 3004 as recorded in the office of the Hamilton County Recorder.

I recommend the Board set a hearing for this proposed drain for September 27, 1999.

KCW/llm



Kenton C. Ward
Hamilton County Surveyor

CERTIFICATE OF COMPLETION AND COMPLIANCE

TO: HAMILTON COUNTY SURVEYOR
RE: Village of WestClay, Section 3001

I hereby certify that:

1. I am a Register Engineer in the State of Indiana
2. I am familiar with the plans and specifications for the above referenced subdivision.
3. I have personally observed and supervised the completion of the Drainage Facilities for the above referenced subdivision, and
4. To the best of my knowledge, information and belief, the Drainage Facilities within the subdivision has been installed and completed in conformity with all plans and specifications.

Signature:  Date: February 17, 2000

Type or print name: Keith Lash, P.E.

Business /Address: The Schneider Corporation

12726 Hamilton Crossing Blvd., Carmel, IN 46032

Telephone: (317) 574-3797

INDIANA REGISTRATION NUMBER

PE 9800085

SEAL



FILED

FEB 18 2000

OFFICE OF HAMILTON COUNTY SURVEYOR

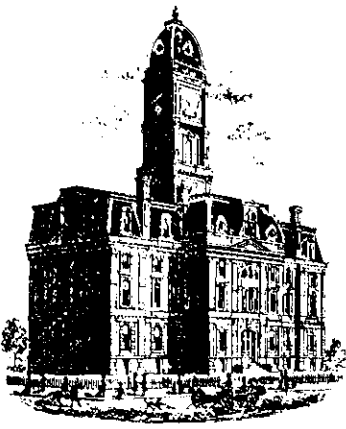

SURVEYOR'S OFFICE

Hamilton County

Kenton C. Ward, Surveyor
 Phone (317) 776-8495
 Fax (317) 776-9628

Suite 188
 One Hamilton County Square
 Noblesville, Indiana 46060-2230

To: Hamilton County Drainage Board

June 24, 2002

Re: Village of West Clay - Sec 3001 Arm

Attached are as-builts, certificate of completion & compliance, and other information for Village of West Clay Section 3001. An inspection of the drainage facilities for this section has been made and the facilities were found to be complete and acceptable.

During construction, changes were made to the drain, which will alter the plans submitted with my report for this drain-dated August 2, 1999. The changes are as follows:

Structure: T.C.: I.E.: Pipe: Length: Original Plans: Difference:

C672		886.13				
C671	890.78	885.63	48	189	195	-6
C671	890.78	885.63				
C670		885.58	48	225	229	-4
C665	893.99	890.44				
C664	893.83	889.93	12	55		
C664	893.83	889.73				
C663	895	889.18	18	129		
C663	895	889.18				
C662	893.87	888.89	18	104		
C662	893.87	888.58				
C661	893.66	888.16	18	61	62	-1
C661	893.66	888.08				
C660	893.62	886.68	21	166		
C660	893.62	886.64				
C659		886.17	21	64	67	-3
C667	893.84	889.94				
C664	893.83	889.93	12	29		
C666	893.77	889.51				
C662	893.87	888.89	12	29		
C641	894.76	888.31				
C640	894.81	888.21	27	33		
C640	894.81	888.11				
C639	894.21	887.56	33	266		

C639	894.21	887.56				
C638	894.16	887.46	33	33	36	-3
C638	894.16	887.46				
C637	891.51	886.77	36	281	280	1
C637	891.51	886.36				
C636	891.89	886.29	36	72		
C636	891.89	886.28				
C635		866.15	36	50	53	-3
C646	893.87	891.39				
C645	894.96	890.56	12	117		
C645	894.96	890.48				
C640	894.81	888.21	12	43	42	1
C647	894.16	890.31				
C639	894.21	887.56	12	59	62	-3
C648	891.53	887.62				
C637	891.51	886.77	15	29		
C612	897.03	893.41				
C630	896.74	893.37	12	25		
C630	896.74	893.34				
C610	896.67	893	15	69		
C611	896.79	893.1				
C610	896.67	893	15	32		
C610	896.67	893.02				
C609	898.82	891.7	21	203		
C609	898.82	891.68				
C608	898.82	890.6	21	116		
C608	898.82	890.58				
C607	897.9	891.2	21	32		
C607	897.9	890.26				
C606	899.31	889.85	27	85		
C606	899.31	899.82				
C605	898.06	892.42	30	215	216	-1
C605	898.06	892.42				
C604	896.95	887.83	30	123	122	1
C604	896.95	887.88				
C603	895.04	888.39	30	106	105	1
C603	895.04	887.31				
C602	895.13	886.71	30	64	65	-1
C602	895.13	886.71				
C601	894.01	886.46	30	74		
C601	894.01	886.38				
C600		885.95	30	68	72	-4
C626	897.38	893.32				
C625	897.48	892.8	12	32		
C625	897.48	893.09				
C607	897.9	891.2	12	69		
C621	897.29	892.66				
C620	897.15	892.5	12	37		
C620	897.15	892.5				

C605	888.71	892.42	12	16		
C615	895.43	891.15				
C603	895.04	888.39	12	56		
C653	897.83	892.03				
C652	897.73	891.59	12	65		
C652	897.73	891.59				
C651	897.8	891.94	12	80		
C651	897.8	891.14				
C650	897.77	890.86	12	79	80	-1
C650	897.77	890.76				
C608	897.9	890.2	12	27	26	1
C655	898.05	891.81				
C650	897.77	890.86	12	66	65	1
C654	897.82	892.11				
C651	897.8	891.94	12	65		
C677	892.49	888.49				
C676	892.5	888.25	12	32		
C676	892.5	888.05				
C675		886.24	12	50	52	-2
C682	891.86	888.03				
C681	891.95	887.9	12	32		
C681	891.95	887.9				
C680		885.65	12	69	70	-1
C679	894.01	886.69				
C678		885.59	21	148	151	-3

RCP Pipe Totals:

	12	1132	
	15	130	
	18	294	
	21	729	
	27	118	
	30	299	650'
	33	403	299'
	36	414	403'
	48	650	414'

TOTAL: 4169

The length of the drain due to the changes described above is now **4,169 feet**.

The non-enforcement for section 3001 was approved by the Board at its meeting on December 13, 1999 and recorded under instrument #2000-00004028. The non-enforcement for section 3001A was approved by the Board at its meeting on September 27, 1999 and recorded under instrument #2000-00004036. The non-enforcement for section 3001B was approved by the Board at its meeting on June 24, 2002 and recorded under instrument #200200044505. The non-enforcement for section 3001C was approved by the Board at its meeting on June 24, 2002 and recorded under instrument #200200044506.

The bond or letter of credit from Harris Bank, number SPL90002673, SPL37089; in the amount of \$9,700.00 and \$341,350; was released October 9, 2000 and May 22, 2000.

I recommend the Board approve the drain's construction as complete and acceptable.

Sincerely,

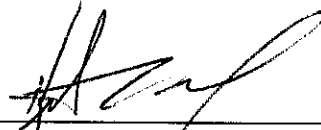
A handwritten signature in black ink, appearing to read 'Kenton C. Ward', written over a horizontal line.

Kenton C. Ward,
Hamilton County Surveyor

KCW/slm

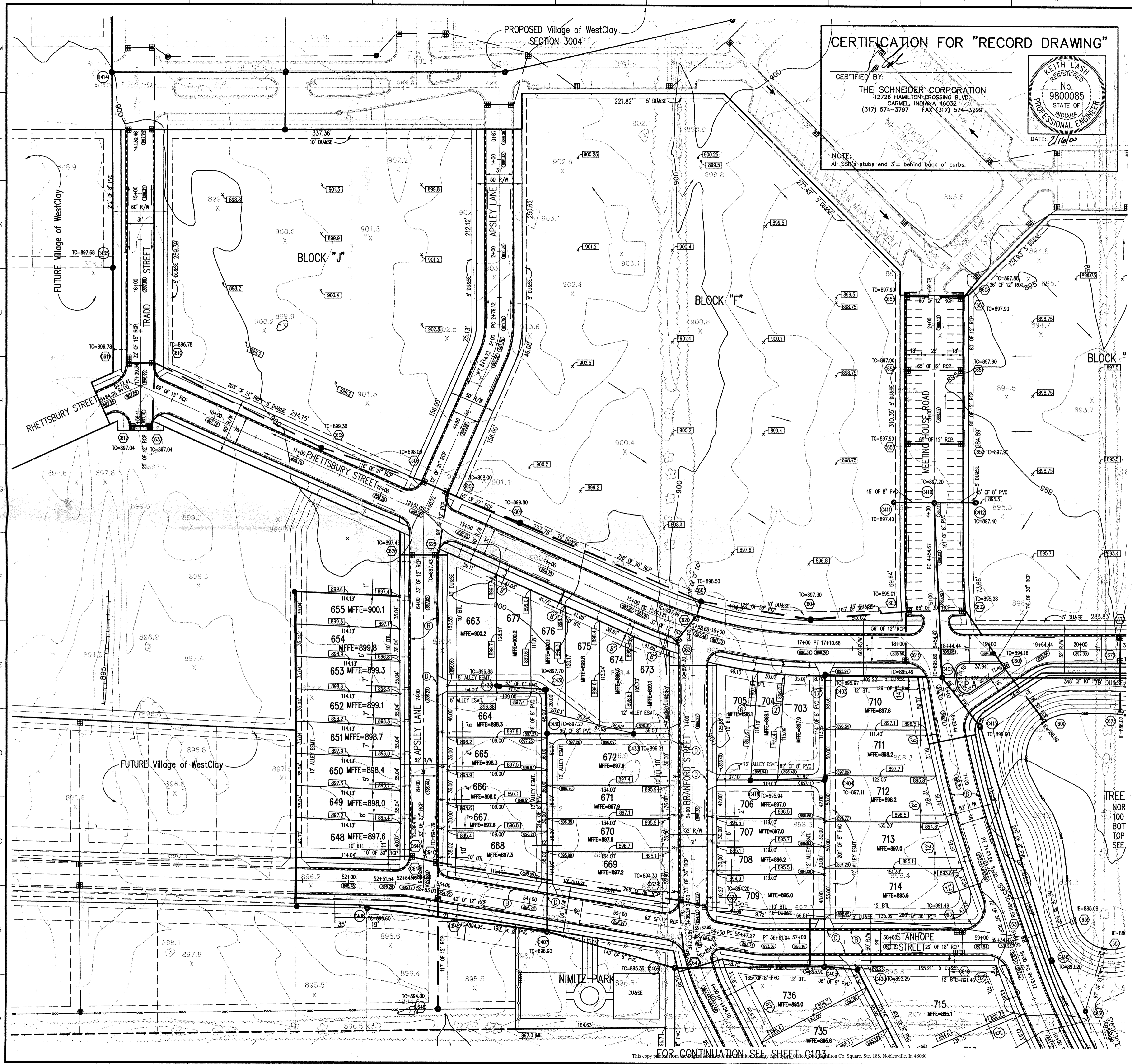

CERTIFICATION FOR "RECORD DRAWING"

CERTIFIED BY:

THE SCHNEIDER CORPORATION
 12726 HAMILTON CROSSING BLVD.
 CARMEL, INDIANA 46032
 (317) 574-3797 FAX (317) 574-3799

NOTE:
 All S&S stubs end 3' behind back of curbs.

KEITH LASH
 REGISTERED
 No. 9800085
 STATE OF INDIANA
 PROFESSIONAL ENGINEER
 DATE: 2/16/00

HOLEY MOLEY SAYS
"DON'T DIG BLIND"

"IT'S THE LAW"
 CALL 2 WORKING DAYS BEFORE YOU DIG
1-800-382-5544

CALL TOLL FREE
 PER INDIANA STATE LAW 15-69-1991,
 IT IS AGAINST THE LAW TO EXCAVATE
 WITHOUT NOTIFYING THE UNDERGROUND
 LOCATION SERVICE TWO (2) WORKING
 DAYS BEFORE COMMENCING WORK.

ASSUMED NORTH
 SCALE: 1"=50'

LEGEND

- Existing Storm Sewer
- New Storm Sewer
- Existing Sanitary Sewer
- New Sanitary Sewer
- Existing Contour
- Existing Elevation w/ description
- New Pavement Grade
- All Other Finish Grades
- Storm Structure Number
- Sanitary Structure Number
- Flow Arrow
- Denotes Elevation and Approximate Pad Size
- 6" Subsurface Drain
- Swale (E)
- 2' Chairback Curb
- 2' Chairback Curb w/o Gutter
- 2' Valley Gutter
- Minimum Finished Floor Elevation

FOR CONTINUATION SEE SHEET C102

SUBSURFACE DRAIN RECORD DRAWING

This information was gathered for input into the Hamilton County Geographical Information System. This document is considered an official record of the.

Entry Date: 5-21-2001
 Entered by: Dawn Jay Gentry

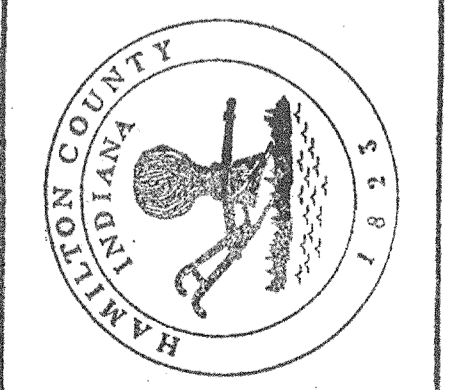

BENCHMARK

TBM #44
 USGS BENCHMARK
 CUT "X" NORTH BONNET BOLT IN FIRE HYDRANT
 EAST SIDE HOOPER RD. ±100' SOUTH OF CLARIDGE
 FARM ENTRANCE.
 ELEVATION = 893.39

GENERAL NOTES

1. ALL GRADES AT BOUNDARY SHALL MEET EXISTING GRADES. IT SHALL BE THE RESPONSIBILITY OF EACH CONTRACTOR TO VERIFY ALL EXISTING UTILITIES AND CONDITIONS PERTAINING TO HIS PHASE OF WORK. IT SHALL ALSO BE THE CONTRACTOR'S RESPONSIBILITY TO CONTACT THE OWNERS OF THE VARIOUS UTILITIES FOR PROPER STAKE LOCATIONS FOR EACH UTILITY BEFORE WORK IS STARTED. THE CONTRACTOR SHALL NOTIFY IN WRITING THE OWNER OR THE ENGINEER OF ANY CHANGES, OMISSIONS, OR ERRORS FOUND ON THESE PLANS OR IN THE FIELD BEFORE WORK IS STARTED OR RESUMED.
2. STANDARD SPECIFICATIONS FOR THE HAMILTON COUNTY SURVEYOR SHALL APPLY FOR ALL STORM SEWERS.
3. STANDARD SPECIFICATIONS FOR CLAY TOWNSHIP REGIONAL WASTE DISTRICT APPLY FOR ALL SANITARY SEWERS.
4. ANY PART OF THE SANITARY OR STORM SEWER TRENCHES RUNNING UNDER PAVED AREAS TO BE BACKFILLED WITH GRANULAR MATERIAL.
5. THE SIZE AND LOCATION OF EXISTING UTILITIES SHOWN ARE PER INFORMATION PROVIDED BY THE RESPECTIVE UTILITY COMPANIES. ALL UTILITY COMPANIES SHOULD BE NOTIFIED PRIOR TO ANY EXCAVATION FOR FIELD LOCATION OF SERVICES.
6. SERVICE WALKS SHALL BE NON-REINFORCED CONCRETE 4" THICK AND 4' IN WIDTH.
7. 4" CONCRETE SERVICE WALK ACROSS FRONTAGE OF EACH LOT TO BE CONSTRUCTED BY OTHERS.
8. EXPANSION JOINTS ARE TO BE PLACED AT ALL WALK INTERSECTIONS AND BETWEEN WALKS AND PLATFORMS. SIDEWALK SCORES ARE TO BE EQUALLY SPACED BETWEEN EXPANSION JOINTS, CONTRACTION JOINTS AND PERPENDICULAR TO SIDEWALKS AT 5' INTERVALS OR LESS WITH A CONTRACTION JOINT EVERY 20' OR LESS.
9. TEMPORARY TRAFFIC CONTROL DURING CONSTRUCTION TO CONFORM TO APPLICABLE LOCAL AND STATE STANDARDS. ALL CONSTRUCTION ACTIVITY ON THIS SITE TO BE PERFORMED IN COMPLIANCE WITH APPLICABLE O.S.H.A. STANDARDS FOR WORKER SAFETY.
10. CONTRACTOR SHALL MINIMIZE DAMAGE TO EXISTING TREES. REMOVE AND BACKFILL ALL AREAS WHERE ANY FIELD TILE CROSSES PROPOSED HOUSE PADS. ALL FIELD TILES INTERCEPTED TO BE PERPETUATED INTO STORM SEWER SYSTEM OR LAKE. THE SUBCONTRACTOR SHALL NOTIFY IN WRITING THE OWNER AND THE ENGINEER IN ANY CIRCUMSTANCES WHERE THIS CANNOT BE ACCOMPLISHED.
11. ALL FILL AREAS SHALL BE COMPACTED TO AT LEAST 95 PERCENT OF THE MAXIMUM DRY DENSITY (ASTM D-1557). FILL UNDER THE FOOTING SHALL BE COMPACTED TO AT LEAST 95 PERCENT OF THE MAXIMUM DRY DENSITY (ASTM D-1557).

Revisions
 1. BET. 05/25/99, REVISED PER TAC COMMENTS.
 2. DEC. 06/14/99, ADDED MFFE PER SURVEYOR'S OFFICE.
 3. BET. 07/18/99, REVISED GRADING TO ACHIEVE EARTHWORK BALANCE.
 4. BET. 12/16/99, "RECORD DRAWING"



CERTIFIED BY _____

THIS DRAWING AND THE DEAS, DESIGNS AND CONCEPTS CONTAINED HEREIN ARE THE EXCLUSIVE INTELLECTUAL PROPERTY OF THE SCHNEIDER CORPORATION AND ARE NOT TO BE USED OR REPRODUCED IN WHOLE OR IN PART, WITHOUT THE WRITTEN CONSENT OF THE SCHNEIDER CORPORATION.

1999, The Schneider Corporation



12726 Hamilton Crossing Blvd. Engineering
 Carmel, Indiana 46032 Surveying
 46032 Landscape Architecture
 317-574-3797 FEB 18 2000 GIS + LIS
 317-574-3797 Geology
 Formerly Schneider Engineering Corp. / Bolton, Meyer, Gibson & Assoc.

BRENWICK DEVELOPMENT CO.
 Village of WestClay
 Section 3001

DEVELOPMENT PLAN

Date	Project No.	Drawn	Apprv.
04/16/99	1238.3001	DCC	
Computer Files	Sheet No.		
J:\1238\3001\DWG\C101.DWG XREF: 3001B, 3001C, 3010B XREF: 1701B, DPROIB, MD-SS XREF: MD-BS-E, PROVOST XREF: CA9, CA10, CA12	C101		

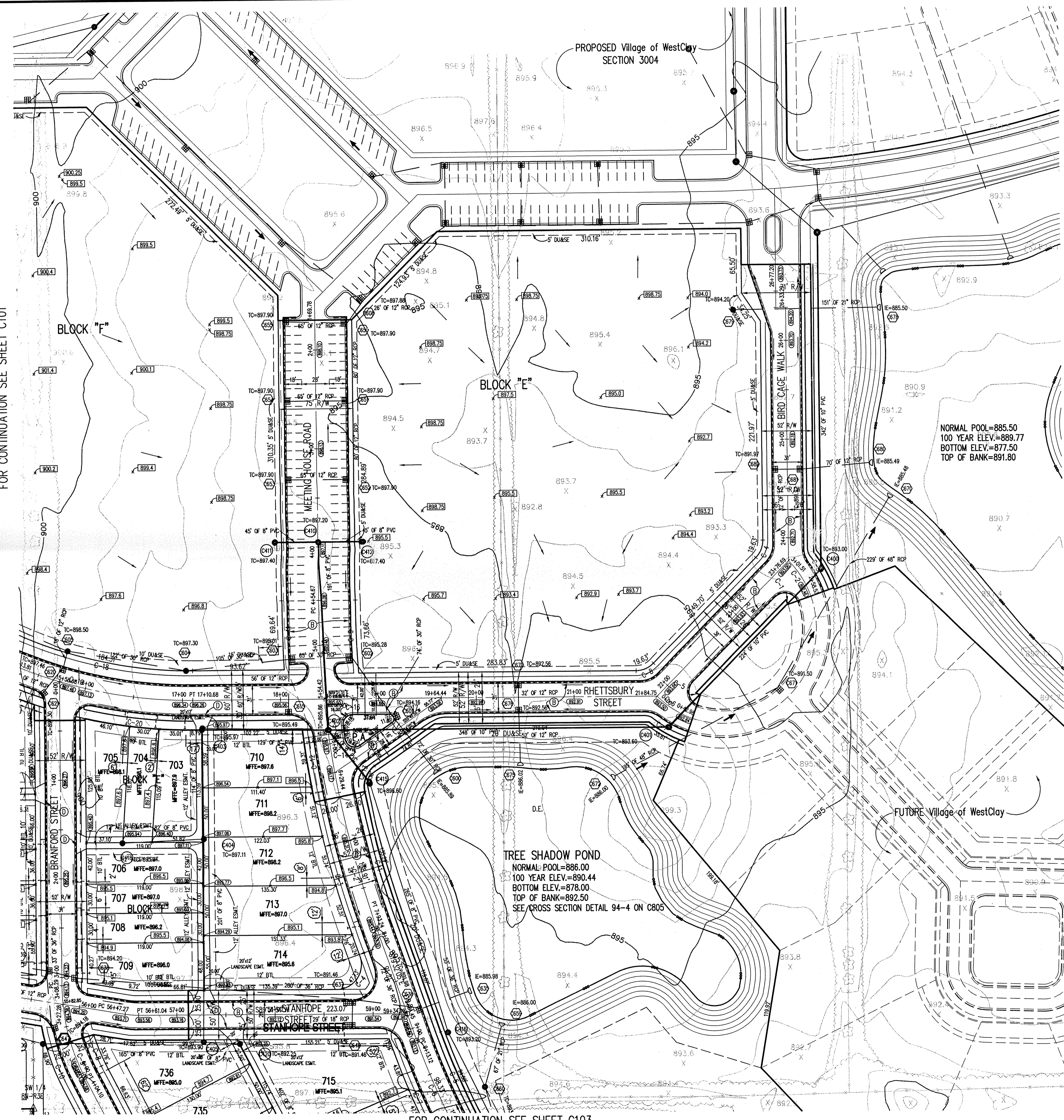

This information was gathered for input from the Hamilton County Geographical Information System (GIS) and is not a substitute for a field survey. Entry Date: 6-21-2001 Entered by: DMW/DPG/ESP



HOLEY MOLEY SAYS
"DON'T DIG BLIND"

"IT'S THE LAW"
 CALL 2 WORKING DAYS BEFORE YOU DIG
1-800-382-5544
 CALL TOLL FREE
 PER INDIANA STATE LAW IS-69-1991. IT IS AGAINST THE LAW TO EXCAVATE WITHOUT NOTIFYING THE UNDERGROUND LOCATION SERVICE TWO (2) WORKING DAYS BEFORE COMMENCING WORK.

ASSUMED NORTH SCALE: 1"=50'

SUBSURFACE DRAIN RECORD DRAWING

LEGEND	
	Existing Storm Sewer
	New Storm Sewer
	Existing Sanitary Sewer
	New Sanitary Sewer
	Existing Contour
	Existing Elevation w/ description
	New Pavement Grade
	All Other Finish Grades
	Storm Structure Number
	Sanitary Structure Number
	Flow Arrow
	Denotes Elevation and Approximate Pad Size
	6" Subsurface Drain
	Swale (ft)
	2' Chairback Curb
	2' Chairback Curb w/o Gutter
	2' Valley Gutter
	Pond Overflow Route
	Minimum Finished Floor Elevation

- ### GENERAL NOTES
- ALL GRADES AT BOUNDARY SHALL MEET EXISTING GRADES. IT SHALL BE THE RESPONSIBILITY OF EACH CONTRACTOR TO VERIFY ALL EXISTING UTILITIES AND CONDITIONS PERTAINING TO HIS PHASE OF WORK. IT SHALL ALSO BE THE CONTRACTOR'S RESPONSIBILITY TO CONTACT THE OWNERS OF THE VARIOUS UTILITIES FOR PROPER STAKE LOCATIONS FOR EACH UTILITY BEFORE WORK IS STARTED. THE CONTRACTOR SHALL NOTIFY IN WRITING THE OWNER OR THE ENGINEER OF ANY CHANGES, OMISSIONS, OR ERRORS FOUND ON THESE PLANS OR IN THE FIELD BEFORE WORK IS STARTED OR RESUMED. STANDARD SPECIFICATIONS FOR THE HAMILTON COUNTY SURVEYOR SHALL APPLY FOR ALL STORM SEWERS.
 - STANDARD SPECIFICATIONS FOR CLAY TOWNSHIP REGIONAL WASTE DISTRICT APPLY FOR ALL SANITARY SEWERS.
 - ANY PART OF THE SANITARY OR STORM SEWER TRENCHES RUNNING UNDER PAVED AREAS TO BE BACKFILLED WITH GRANULAR MATERIAL.
 - THE SIZE AND LOCATION OF EXISTING UTILITIES SHOWN ARE PER INFORMATION PROVIDED BY THE RESPECTIVE UTILITY COMPANIES. ALL UTILITY COMPANIES SHOULD BE NOTIFIED PRIOR TO ANY EXCAVATION FOR FIELD LOCATION OF SERVICES.
 - SERVICE WALKS SHALL BE NON-REINFORCED CONCRETE 4" THICK AND 4" IN WIDTH.
 - CONCRETE SERVICE WALK ACROSS FRONTAGE OF EACH LOT TO BE CONSTRUCTED BY OTHERS.
 - EXPANSION JOINTS ARE TO BE PLACED AT ALL WALK INTERSECTIONS AND BETWEEN WALKS AND PLATFORMS. SIDEWALK SPACES ARE TO BE EQUALLY SPACED BETWEEN EXPANSION JOINTS, CONTRACTION JOINTS AND PERPENDICULAR TO SIDEWALKS AT 5' INTERVALS OR LESS WITH A CONTRACTION JOINT EVERY 20' OR LESS.
 - TEMPORARY TRAFFIC CONTROL DURING CONSTRUCTION TO CONFORM TO APPLICABLE LOCAL AND STATE STANDARDS. ALL CONSTRUCTION ACTIVITY ON THIS SITE TO BE PERFORMED IN COMPLIANCE WITH APPLICABLE O.S.H.A. STANDARDS FOR WORKER SAFETY.
 - CONTRACTOR SHALL MINIMIZE DAMAGE TO EXISTING TREES. REMOVE AND BACKFILL ALL AREAS WHERE ANY FIELD TILE CROSSES PROPOSED HOUSE PADS. ALL FIELD TILES INTERCEPTED TO BE PERPETUATED INTO STORM SEWER SYSTEM OR LAKE. THE SUBCONTRACTOR SHALL NOTIFY IN WRITING THE OWNER AND THE ENGINEER IN ANY CIRCUMSTANCES WHERE THIS CANNOT BE ACCOMPLISHED. ALL FILL AREAS SHALL BE COMPACTED TO AT LEAST 95 PERCENT OF THE MAXIMUM DRY DENSITY (ASTM D-1557). FILL UNDER THE FOOTING SHALL BE COMPACTED TO AT LEAST 95 PERCENT OF THE MAXIMUM DRY DENSITY (ASTM D-1557).

Revisions
 1. BET. 05/25/99, REVISED PER TAC COMMENTS.
 2. DOC 6/14/99, ADDED MFE PER SURVEYOR'S OFFICE.
 3. BET. 07/19/99, REVISED GRADING TO ACHIEVE EARTHWORK BALANCE.
 4. BET. 12/16/99, "RECORD DRAWING"



CERTIFICATION FOR "RECORD DRAWING"

CERTIFIED BY:
 THE SCHNEIDER CORPORATION
 12726 HAMILTON CROSSING BLVD.
 CARMEL, INDIANA 46032
 (317) 574-3797 FAX (317) 574-3799

NOTE:
 All SDD's stubs end 3'± behind back of curbs.



1999, The Schneider Corporation

The Schneider Corporation
 12726 Hamilton Crossing Blvd. Engineering
 Carmel, Indiana 46032 Surveying
 317-574-3797 Landscape Architecture
 317-574-3797 • LIS
 317-574-3799 Fax • Geology
 FEB 18 2000
 Formerly Schneider Engineering, Inc. / Shellen, Meyer, Gibson & Assoc.

BENCHMARK

TBM #44
 USGS BENCHMARK
 CUT "X" NORTH BONNET BOLT IN FIRE HYDRANT
 EAST SIDE HOOVER RD. ±100' SOUTH OF CLARIDGE
 FARM ENTRANCE.
 ELEVATION - 893.39

DEVELOPMENT PLAN			
Date	Project No.	Drawn	Apprv.
04/16/99	1238.3001	DCC	
Computer Files			Sheet No.
1238.3001\DWG\C102.DWG XREF: 300IBS, 300IAB XREF: MD-BS-E, HARRISON XREF: CA9, CA10, CA12 XREF: 300IBS, PROVOST			C102

HOLEY MOLEY SAYS



"DON'T DIG BLIND"

"IT'S THE LAW" CALL 2 WORKING DAYS BEFORE YOU DIG 1-800-382-5544

PER INDIANA STATE LAW IS-69-1991. IT IS AGAINST THE LAW TO EXCAVATE WITHOUT NOTIFYING THE UNDERGROUND LOCATION SERVICE TWO (2) WORKING DAYS BEFORE COMMENCING WORK.

ASSUMED NORTH SCALE: 1"=50'

LEGEND

- Existing Storm Sewer
New Storm Sewer
Existing Sanitary Sewer
New Sanitary Sewer
Existing Contour
Existing Elevation w/ description
New Pavement Grade
All Other Finish Grades
Storm Structure Number
Sanitary Structure Number
Flow Arrow
Denotes Elevation and Approximate Pad Size
6" Subsurface Drain
Swale (ft)
2' Chairback Curb
2' Chairback Curb w/o Gutter
2' Valley Gutter
Minimum Finished Floor Elevation

GENERAL NOTES

- 1. ALL GRADES AT BOUNDARY SHALL MEET EXISTING GRADES.
2. IT SHALL BE THE RESPONSIBILITY OF EACH CONTRACTOR TO VERIFY ALL EXISTING UTILITIES AND CONDITIONS PERTAINING TO HIS PHASE OF WORK.
3. THE CONTRACTOR'S RESPONSIBILITY TO CONTACT THE OWNERS OF THE VARIOUS UTILITIES FOR PROPER STAKE LOCATIONS FOR EACH UTILITY BEFORE WORK IS STARTED.
4. THE CONTRACTOR SHALL NOTIFY IN WRITING THE OWNER OR THE ENGINEER OF ANY CHANGES, OMISSIONS, OR ERRORS FOUND ON THESE PLANS OR IN THE FIELD BEFORE WORK IS STARTED OR RESUMED.
5. STANDARD SPECIFICATIONS FOR THE HAMILTON COUNTY SURVEYOR SHALL APPLY FOR ALL STORM SEWERS.
6. STANDARD SPECIFICATIONS FOR CLAY TOWNSHIP REGIONAL WASTE DISTRICT APPLY FOR ALL SANITARY SEWERS.
7. ANY PART OF THE SANITARY OR STORM SEWER TRENCHES RUNNING UNDER PAVED AREAS TO BE BACKFILLED WITH GRANULAR MATERIAL.
8. THE SIZE AND LOCATION OF EXISTING UTILITIES SHOWN ARE PER INFORMATION PROVIDED BY THE RESPECTIVE UTILITY COMPANIES. ALL UTILITY COMPANIES SHOULD BE NOTIFIED PRIOR TO ANY EXCAVATION FOR FIELD LOCATION OF SERVICES.
9. SERVICE WALKS SHALL BE NON-REINFORCED CONCRETE 4" THICK AND 4' IN WIDTH.
10. 4' CONCRETE SERVICE WALK ACROSS FRONTAGE OF EACH LOT TO BE CONSTRUCTED BY OTHERS.
11. EXPANSION JOINTS ARE TO BE PLACED AT ALL WALK INTERSECTIONS AND BETWEEN WALKS AND PLATFORMS. SIDEWALK SCORES ARE TO BE EQUALLY SPACED BETWEEN EXPANSION JOINTS, CONTRACTION JOINTS AND PERPENDICULAR TO SIDEWALKS AT 5' INTERVALS OR LESS WITH A CONTRACTION JOINT EVERY 20' OR LESS.
12. TEMPORARY TRAFFIC CONTROL DURING CONSTRUCTION TO CONFORM TO APPLICABLE LOCAL AND STATE STANDARDS. ALL CONSTRUCTION ACTIVITY ON THIS SITE TO BE PERFORMED IN COMPLIANCE WITH APPLICABLE O.S.H.A. STANDARDS FOR WORKER SAFETY.
13. CONTRACTOR SHALL MINIMIZE DAMAGE TO EXISTING TREES. REMOVE AND BACKFILL ALL AREAS WHERE ANY FIELD TILE CROSSES PROPOSED HOUSE PADS. ALL FIELD TILES INTERCEPTED TO BE PERPETUATED INTO STORM SEWER SYSTEM OR LAKE. THE SUBCONTRACTOR SHALL NOTIFY IN WRITING THE OWNER AND THE ENGINEER IN ANY CIRCUMSTANCES WHERE THIS CANNOT BE ACCOMPLISHED. ALL FILL AREAS SHALL BE COMPACTED TO AT LEAST 95 PERCENT OF THE MAXIMUM DRY DENSITY (ASTM D-1557). FILL UNDER THE FOOTING SHALL BE COMPACTED TO AT LEAST 95 PERCENT OF THE MAXIMUM DRY DENSITY (ASTM D-1557).

- Revisions
1. BET. 05/25/99, REVISED PER TAC COMMENTS.
2. DEC 6/14/99, ADDED MFE PER SURVEYOR'S OFFICE.
3. BET. 07/18/99, REVISED DRAWING TO ACHIEVE EARTHWORK BALANCE.
4. BET. 09/17/99, REVISED ALLEY SOUTHWEST OF LOT 741.
5. BET. 12/16/99, "RECORD DRAWING"

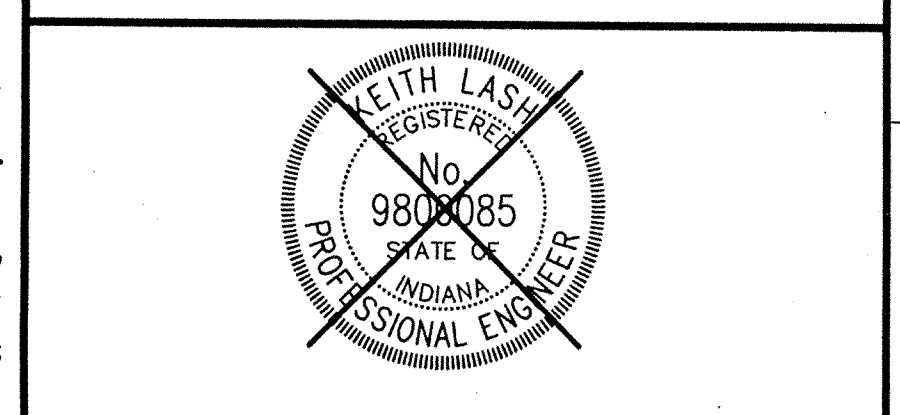

CERTIFIED BY: THE SCHNEIDER CORPORATION, 12726 HAMILTON CROSSING BLVD., CARMEL, INDIANA 46032, (317) 574-3797, FAX (317) 574-3799

The Schneider Corporation logo and address: 12726 Hamilton Crossing Blvd., Carmel, Indiana 46032. Includes contact info for Engineering, Surveying, and Architecture.

BRENNICK DEVELOPMENT CO. Village of WestClay Section 3001

DEVELOPMENT PLAN

Table with columns: Date (04/16/99), Project No. (1238.3001), Drawn (DCC), Approv. (DCC), Computer File, and Sheet No. (C103)

SUBSURFACE DRAIN RECORD DRAWING

TREE SHADOW POND
NORMAL POOL=886.00
100 YEAR ELEV.=890.44
BOTTOM ELEV.=878.00
TOP OF BANK=892.50
SEE CROSS SECTION DETAIL 94-4 ON C805

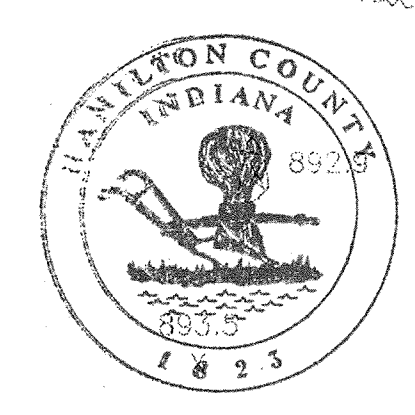

This information was gathered from... Entry Date: 8-21-001, Entered by: DMW J016 6/24/01

CERTIFICATION FOR "RECORD DRAWING"

CERTIFIED BY: THE SCHNEIDER CORPORATION, 12726 HAMILTON CROSSING BLVD., CARMEL, INDIANA 46032, (317) 574-3797, FAX (317) 574-3799

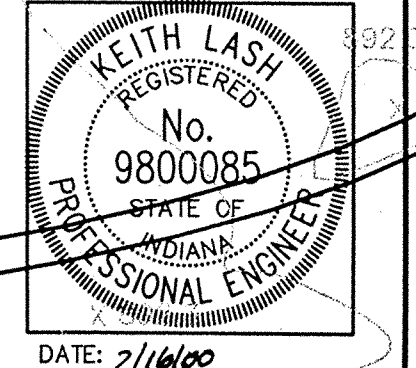

NOTE: All SSD's stubs end 3'± behind back of curbs.

BENCHMARK

TBM #44 USGS BENCHMARK CUT "X" NORTH BONNET BOLT IN FIRE HYDRANT EAST SIDE HOOPER RD. ±100' SOUTH OF CLARIDGE FARM ENTRANCE. ELEVATION - 893.39

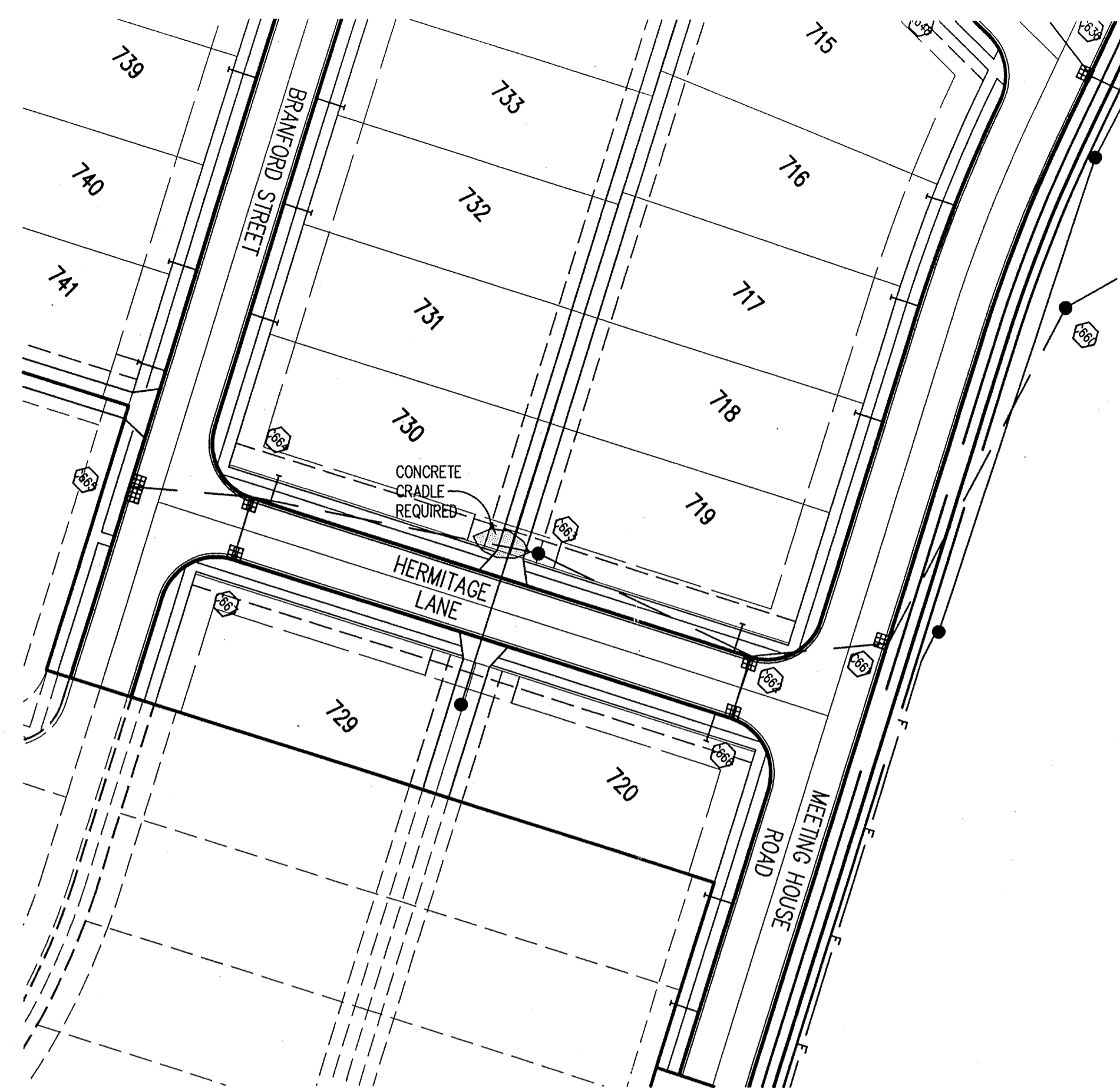
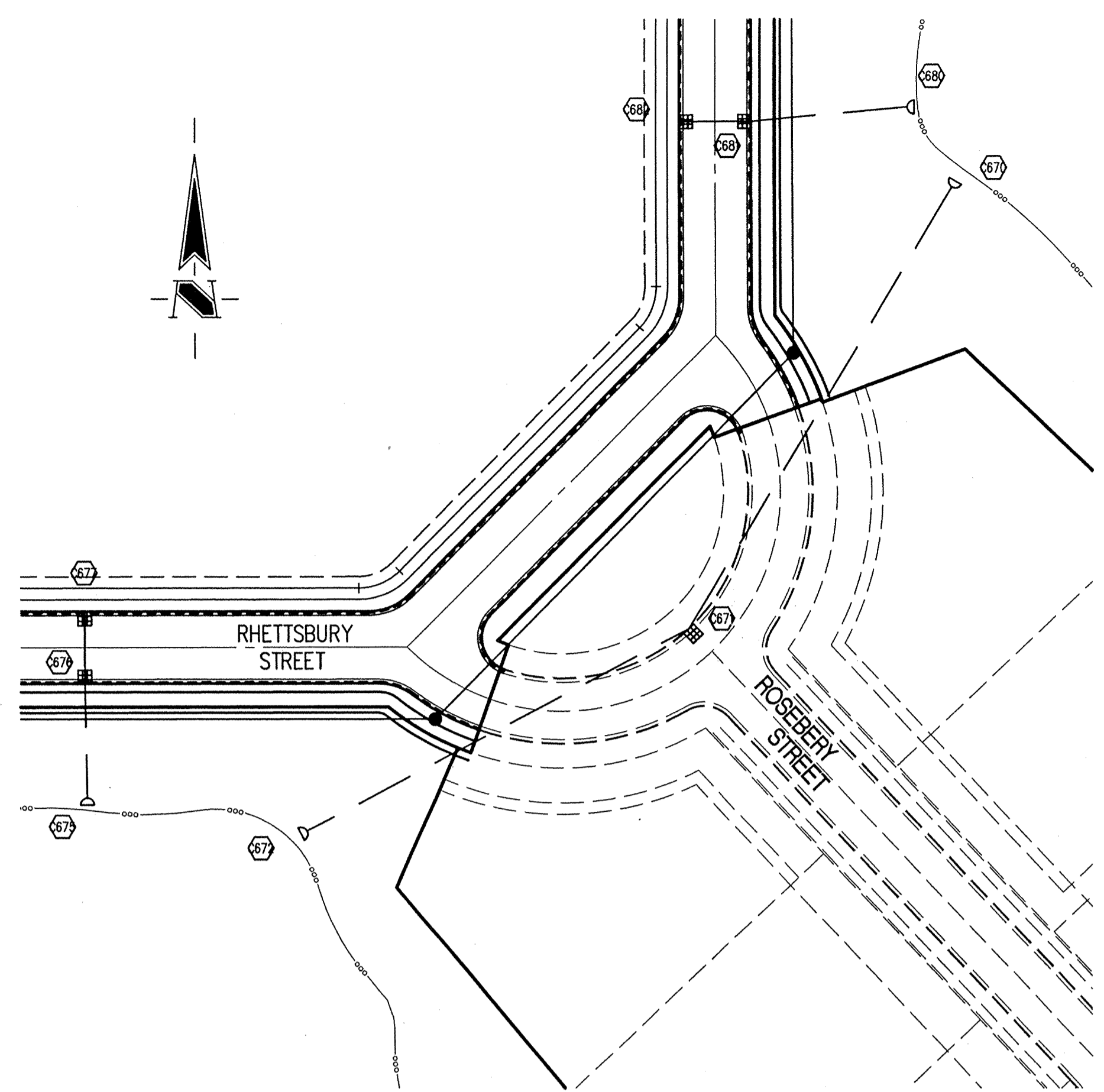

HAMILTON COUNTY INDIANA
 This information was gathered for input into the Hamilton County Geographical Information System. This document is considered an official record of the GIS.
 Entry Date: 8-21-2001
 Entered by: DAW/JOH 679-89

HOLEY MOLEY SAYS
"DON'T DIG BLIND"
"IT'S THE LAW"
 CALL 2 WORKING DAYS BEFORE YOU DIG
1-800-382-5544
 CALL TOLL FREE
 PER INDIANA STATE LAW IS-69-1991:
 IT IS AGAINST THE LAW TO EXCAVATE WITHOUT NOTIFYING THE UNDERGROUND LOCATION SERVICE TWO (2) WORKING DAYS BEFORE COMMENCING WORK.

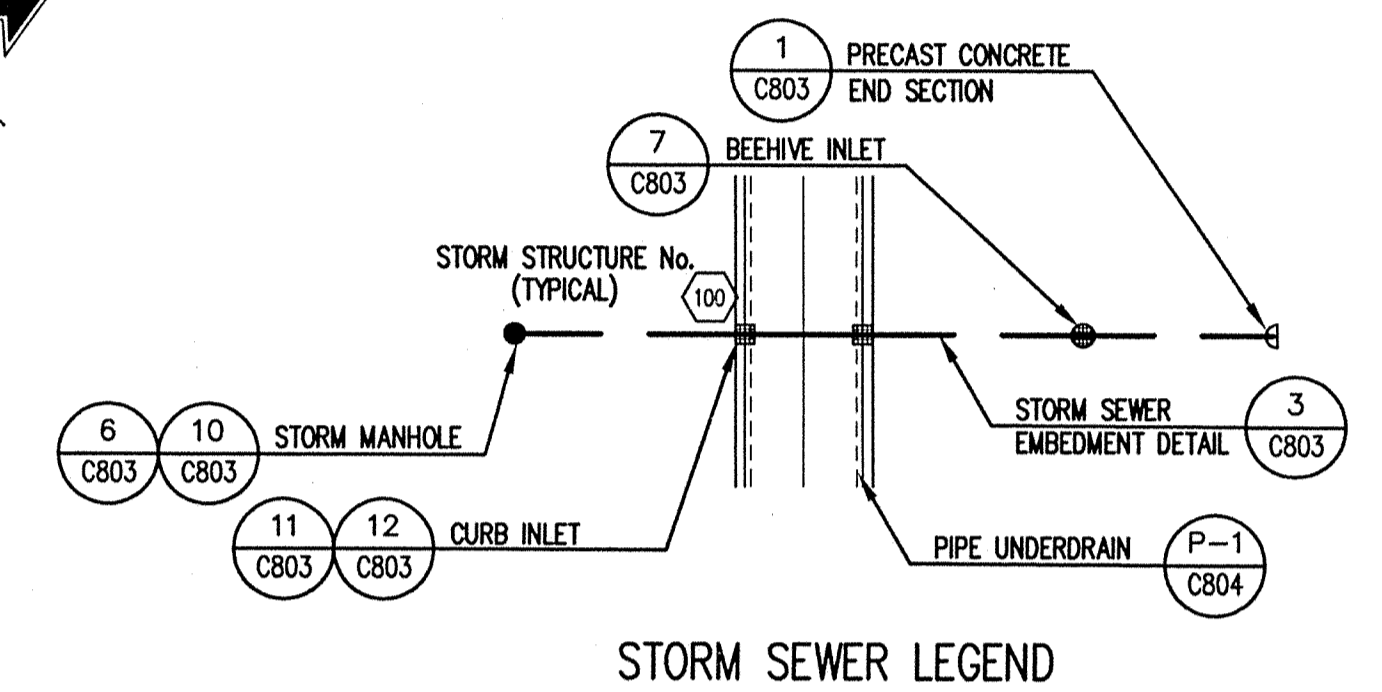

GENERAL NOTES

- TEMPORARY TRAFFIC CONTROL DURING CONSTRUCTION TO CONFORM TO APPLICABLE LOCAL AND STATE STANDARDS.
- ALL CONSTRUCTION ACTIVITY ON THIS SITE TO BE PERFORMED IN COMPLIANCE WITH APPLICABLE O.S.H.A. STANDARDS FOR WORKER SAFETY.
- IT SHALL BE THE CONTRACTORS RESPONSIBILITY TO FIELD VERIFY ALL UTILITY LOCATIONS BEFORE CONSTRUCTION BEGINS.
- CONTRACTORS SHALL MINIMIZE DAMAGE TO EXISTING TREES.

BENCHMARK

TBM #44
 USGS BENCHMARK
 CUT "X" NORTH BONNET BOLT IN FIRE HYDRANT
 EAST SIDE HOOVER RD. ±100' SOUTH OF CLARIDGE FARM ENTRANCE.
 ELEVATION - 893.39

Revisions

- 03/5/10/99: EDITED LEGEND.
- BET. 05/25/99, REVISED PER TAC COMMENTS.
- BET. 06/24/99, REVISED STORM SEWERS AND POND GEOMETRY.
- 07/19/99, DCC REVISED GRADINGS TO ACHIEVE EARTHWORK BALANCE.
- BET. 12/16/99, "RECORD DRAWING"

STORM SEWER PLAN

SCALE: 1"=50'

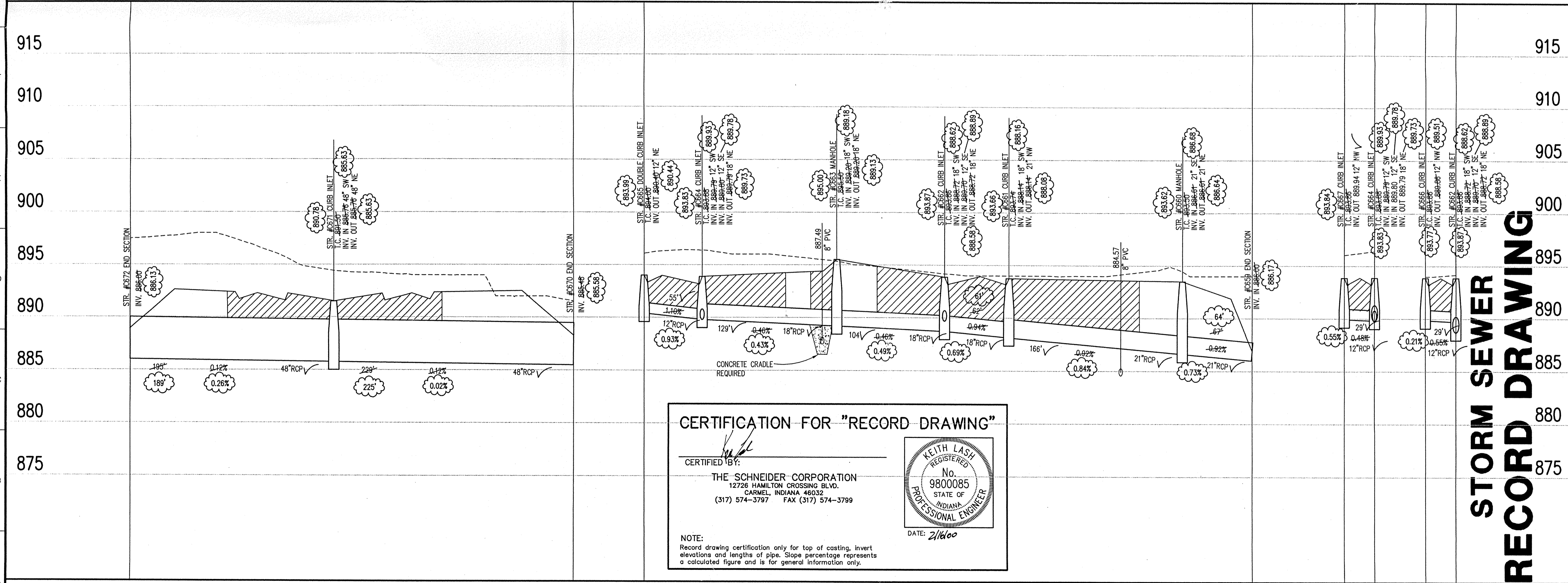

STORM SEWER RECORD DRAWING

CERTIFIED BY: _____

THIS DRAWING AND THE IDEAS, DESIGNS AND CONCEPTS CONTAINED HEREIN ARE THE EXCLUSIVE INTELLECTUAL PROPERTY OF THE SCHNEIDER CORPORATION AND ARE NOT TO BE USED OR REPRODUCED IN WHOLE OR IN PART, WITHOUT THE WRITTEN CONSENT OF THE SCHNEIDER CORPORATION.

1999, The Schneider Corporation

The Schneider Corporation
 12726 Hamilton Crossing Blvd. Engineering
 Carmel, Indiana 46032 Surveying
 317-574-3797 Landscape Architecture
 317-574-3799 Fax 1 8 2000 GIS
 Formerly Schneider Engineering, Surveying, Landscape Architecture, GIS, LIS, Geology

BRUNWICK DEVELOPMENT CO.
 Village of WestClay
 Section 3001

STORM SEWER PROFILE

LEGEND

	Existing Grade
	New Grade
	Granular Backfill

SCALE: HORZ.: 1"=50'
 VERT.: 1"=5'

Date	Project No.	Drawn	Apprv.
04/16/99	1238.3001	MG	
Computer Files		Sheet No.	
A:\1238\3001\DWG\C601.DWG XREF: 3001BS.DWG, 3004BS.DWG XREF: MD-BS.DWG, MD-BS-EDWG XREF: SOU-BS.DWG, STORM.DWG		C601	

I:\1238\3001\DWG\C601.dwg Tue Feb 08 14:58:10 2000

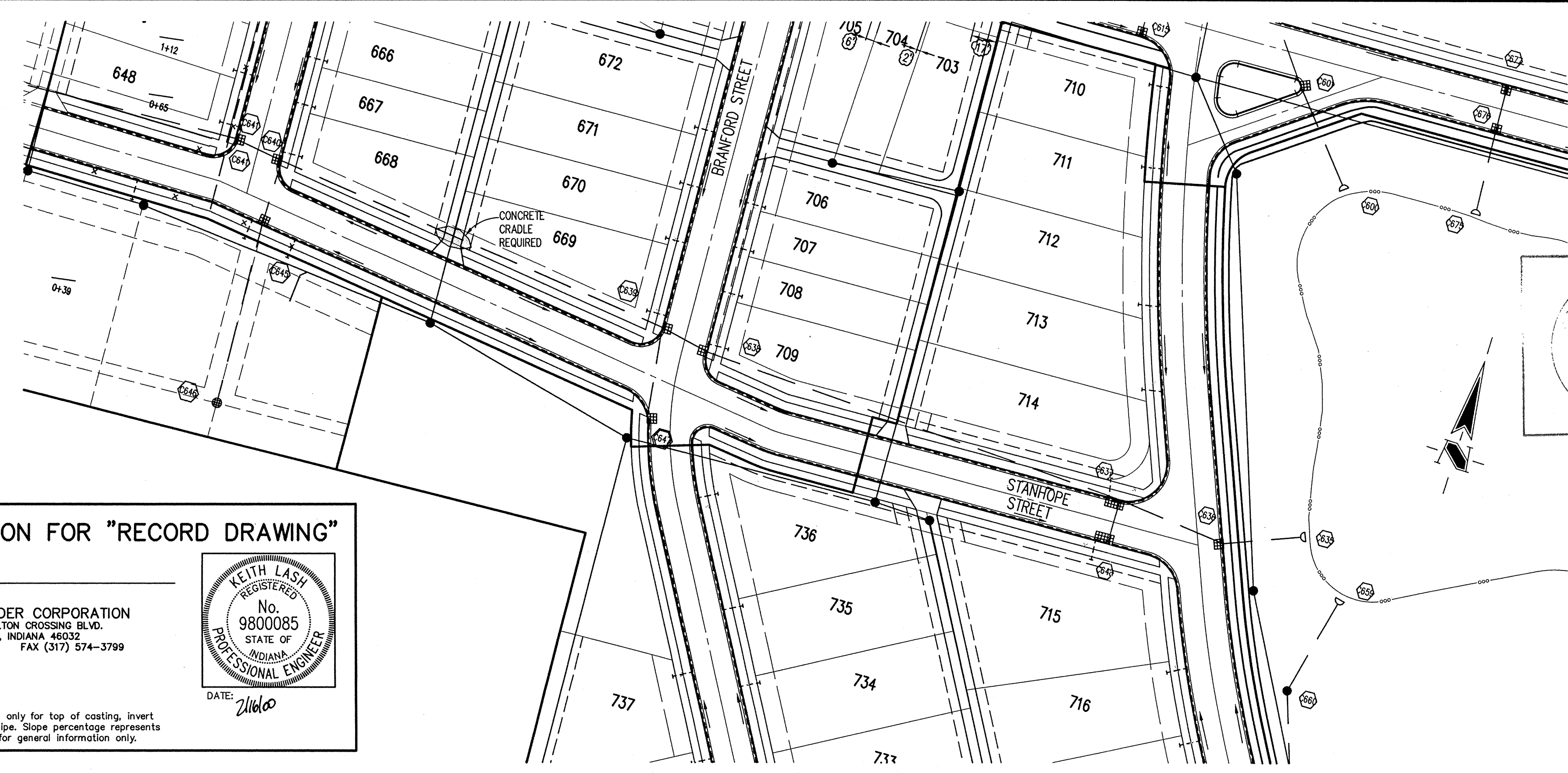

HOLEY MOLEY SAYS
"DON'T DIG BLIND"

"IT'S THE LAW"
 CALL 2 WORKING DAYS BEFORE YOU DIG
1-800-382-5544
 CALL TOLL FREE
 PER INDIANA STATE LAW IS-69-1991,
 IT IS AGAINST THE LAW TO EXCAVATE
 WITHOUT NOTIFYING THE UNDERGROUND
 LOCATION SERVICE TWO (2) WORKING
 DAYS BEFORE COMMENCING WORK.

AMILTON COUNTY
 INDIANA
 1823

This information was gathered for input into the Hamilton County Geographic Information System. It was prepared and considered an official record of the GIS.

Entry Date: 8-21-2001

Entered by: DMW JSA 628-04

CERTIFICATION FOR "RECORD DRAWING"

CERTIFIED BY:

THE SCHNEIDER CORPORATION
 12726 HAMILTON CROSSING BLVD.
 CARMEL, INDIANA 46032
 (317) 574-3797 FAX (317) 574-3799

KEITH LASH
 REGISTERED
 No. 9800085
 STATE OF INDIANA
 PROFESSIONAL ENGINEER

DATE: 2/16/00

NOTE:
 Record drawing certification only for top of casting, invert elevations and lengths of pipe. Slope percentage represents a calculated figure and is for general information only.

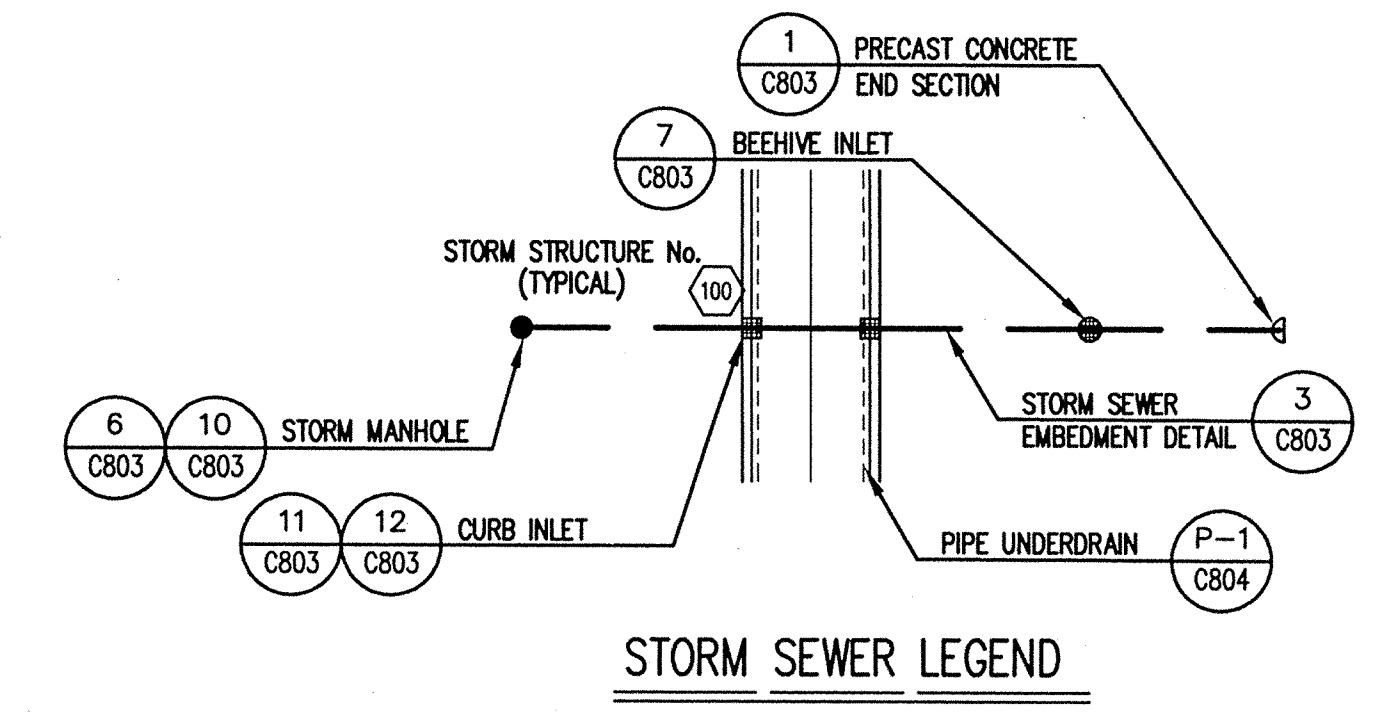

GENERAL NOTES

- TEMPORARY TRAFFIC CONTROL DURING CONSTRUCTION TO CONFORM TO APPLICABLE LOCAL AND STATE STANDARDS.
- ALL CONSTRUCTION ACTIVITY ON THIS SITE TO BE PERFORMED IN COMPLIANCE WITH APPLICABLE O.S.H.A. STANDARDS FOR WORKER SAFETY.
- IT SHALL BE THE CONTRACTORS RESPONSIBILITY TO FIELD VERIFY ALL UTILITY LOCATIONS BEFORE CONSTRUCTION BEGINS.
- CONTRACTORS SHALL MINIMIZE DAMAGE TO EXISTING TREES.

BENCHMARK

TBM #44
 USGS BENCHMARK
 CUT "X" NORTH BONNET BOLT IN FIRE HYDRANT
 EAST SIDE HOOVER RD. ±100' SOUTH OF CLARIDGE
 FARM ENTRANCE.
 ELEVATION - 893.39

STORM SEWER PLAN

SCALE: 1"=50'

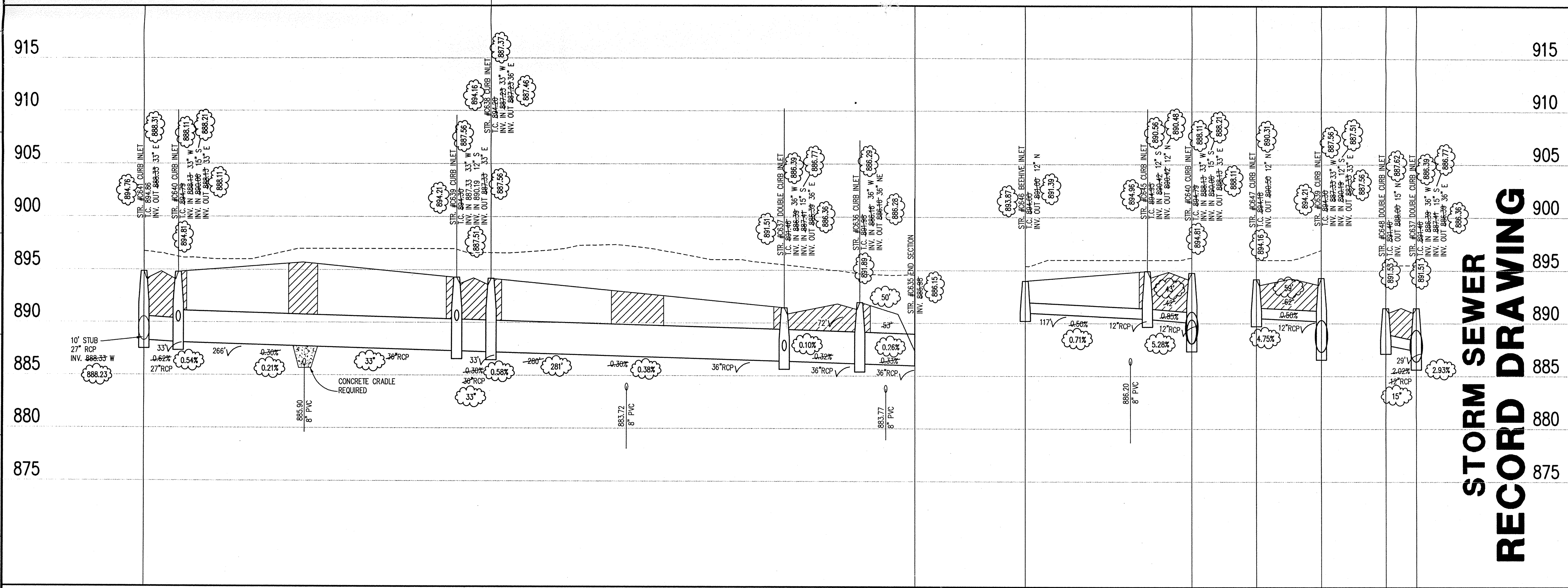

STORM SEWER PROFILE

SCALE: HORZ.: 1"=50'
 VERT.: 1"=5'

LEGEND

	Existing Grade
	New Grade
	Granular Backfill

Revisions

- DCC 5/10/99; EDITED LEGEND
- BET, 06/24/99; REVISED STORM SEWERS AND POND GEOMETRY.
- 07/19/99, DCC; REVISED GRADING TO ACHIEVE EARTHWORK BALANCE.
- BET, 12/16/99, "RECORD DRAWING"

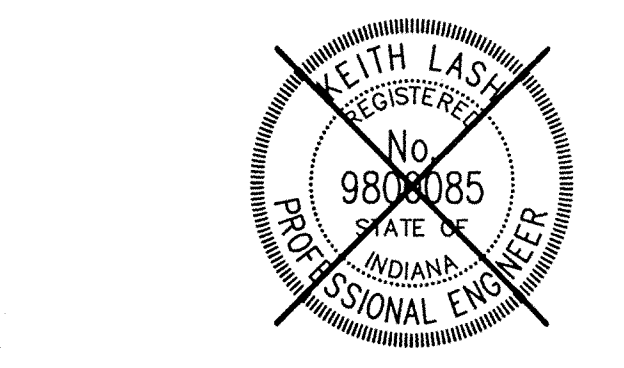

CERTIFIED BY: _____

THIS DRAWING AND THE IDEAS, DESIGNS AND CONCEPTS CONTAINED HEREIN ARE THE EXCLUSIVE INTELLECTUAL PROPERTY OF THE SCHNEIDER CORPORATION AND ARE NOT TO BE USED OR REPRODUCED IN WHOLE OR IN PART, WITHOUT THE WRITTEN CONSENT OF THE SCHNEIDER CORPORATION.

1999, The Schneider Corporation

The Schneider Corporation

12726 Hamilton Crossing Blvd. Engineering
 Carmel, Indiana 46032 Surveying
 46032 Landscape Architecture
 317-574-3797
 317-574-3799 FAX
 HAMILTON COUNTY SURVEYING

Formerly Schneider Engineering Corp. / Bohlen, Meyer, Gibson & Assoc.

BRENNICK DEVELOPMENT CO.
 Village of WestClay
 Section 3001

STORM SEWER PLAN

Date	Project No.	Drawn	Approv.
04/16/99	1238.3001	MG	

Computer Files
 4: \1238.3001\DWG\0202.DWG
 XREF: 3001BS.DWG; 3004BS.DWG
 XREF: MD-BS.DWG; MD-BS-EDWG
 XREF: SOU-BS.DWG; STORM.DWG
 XREF: 7501BS.DWG

Sheet No.
C602

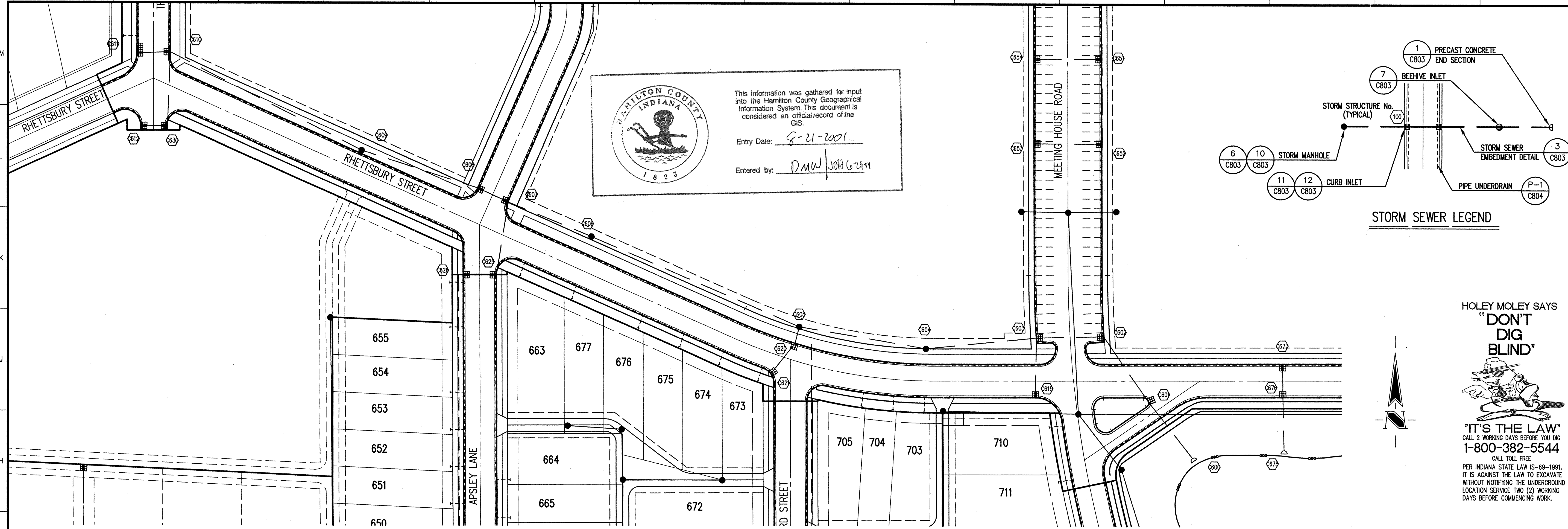

MILTON COUNTY INDIANA
 This information was gathered for input into the Hamilton County Geographical Information System. This document is considered an official record of the GIS.
 Entry Date: 8-21-2001
 Entered by: DMW/JOB G-244

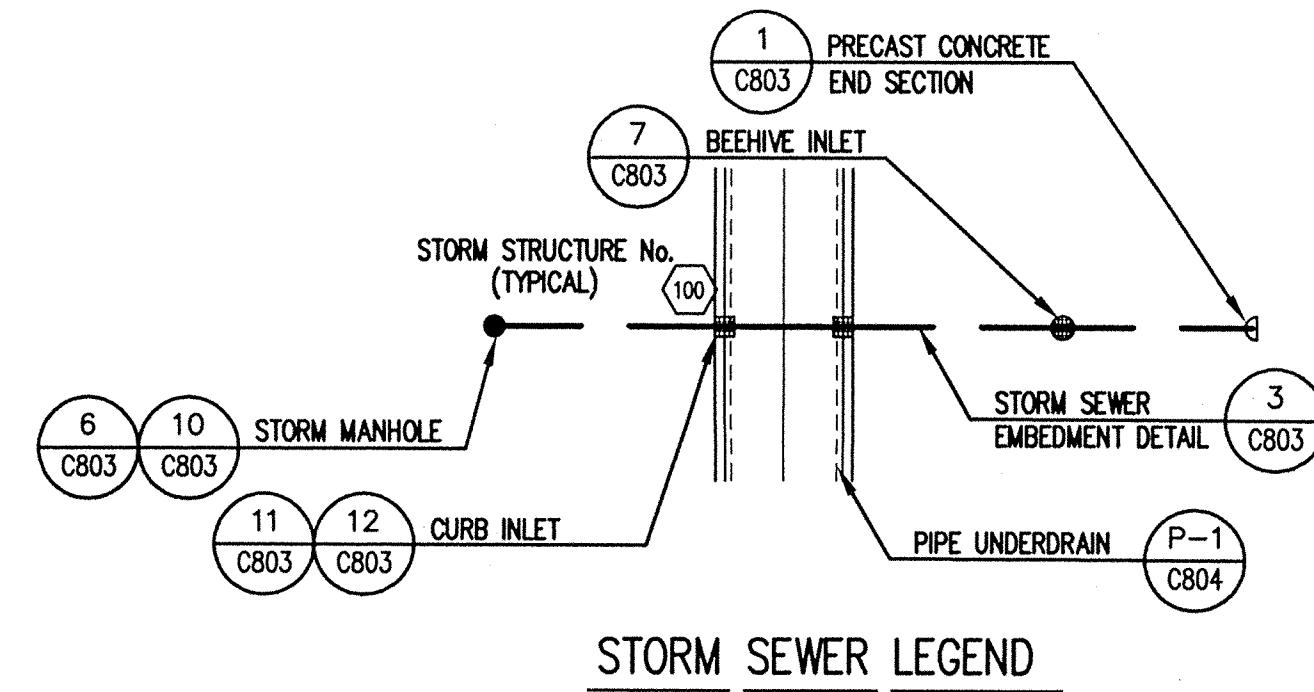

HOLEY MOLEY SAYS
 "DON'T DIG BLIND"
 "IT'S THE LAW"
 CALL 2 WORKING DAYS BEFORE YOU DIG
 1-800-382-5544
 CALL TOLL FREE
 PER INDIANA STATE LAW IS-69-1991, IT IS AGAINST THE LAW TO EXCAVATE WITHOUT NOTIFYING THE UNDERGROUND LOCATION SERVICE TWO (2) WORKING DAYS BEFORE COMMENCING WORK.

GENERAL NOTES

- TEMPORARY TRAFFIC CONTROL DURING CONSTRUCTION TO CONFORM TO APPLICABLE LOCAL AND STATE STANDARDS.
- ALL CONSTRUCTION ACTIVITY ON THIS SITE TO BE PERFORMED IN COMPLIANCE WITH APPLICABLE O.S.H.A. STANDARDS FOR WORKER SAFETY.
- IT SHALL BE THE CONTRACTORS RESPONSIBILITY TO FIELD VERIFY ALL UTILITY LOCATIONS BEFORE CONSTRUCTION BEGINS.
- CONTRACTORS SHALL MINIMIZE DAMAGE TO EXISTING TREES.

BENCHMARK

TBM #44
 USGS BENCHMARK
 CUT "X" NORTH BONNET BOLT IN FIRE HYDRANT
 EAST SIDE HOOVER RD. ±100' SOUTH OF CLARIDGE FARM ENTRANCE.
 ELEVATION - 893.39

STORM SEWER PLAN

SCALE: 1"=50'

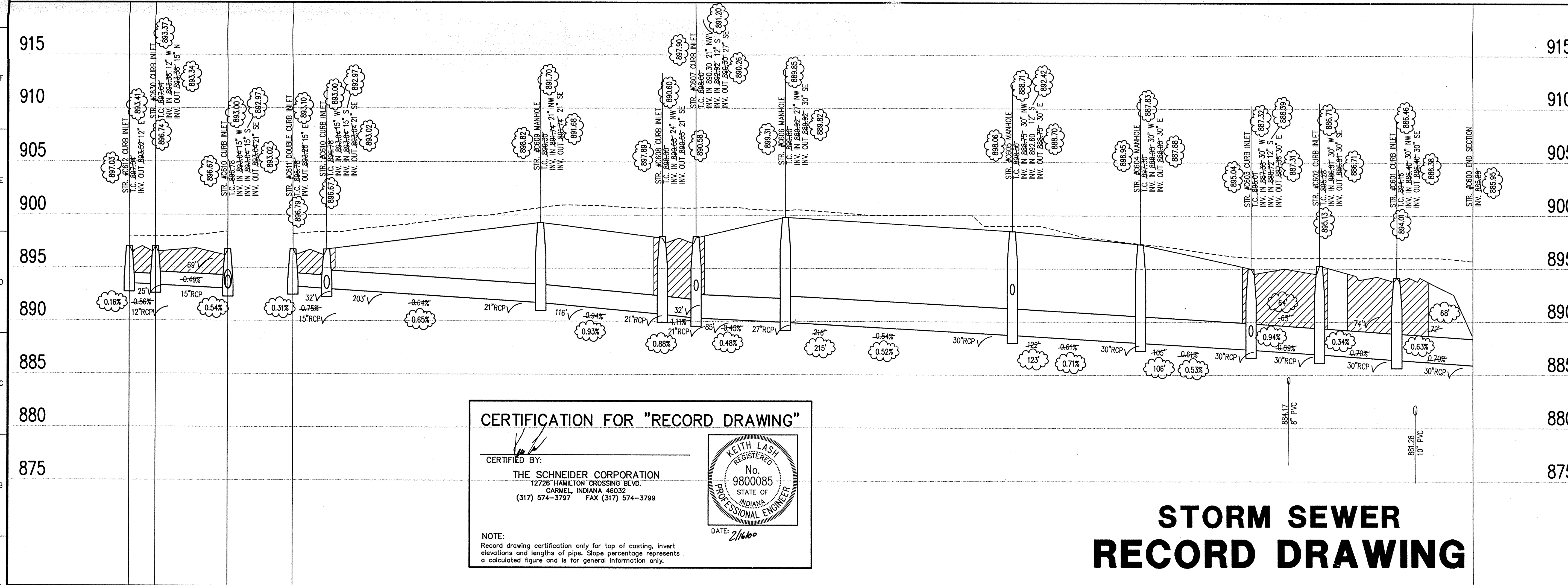

CERTIFICATION FOR "RECORD DRAWING"

CERTIFIED BY:
 THE SCHNEIDER CORPORATION
 12726 HAMILTON CROSSING BLVD.
 CARMEL, INDIANA 46032
 (317) 574-3797 FAX (317) 574-3799

KEITH LASH REGISTERED No. 9800085 STATE OF INDIANA PROFESSIONAL ENGINEER
 DATE: 2/16/00

NOTE:
 Record drawing certification only for top of casting, invert elevations and lengths of pipe. Slope percentage represents a calculated figure and is for general information only.

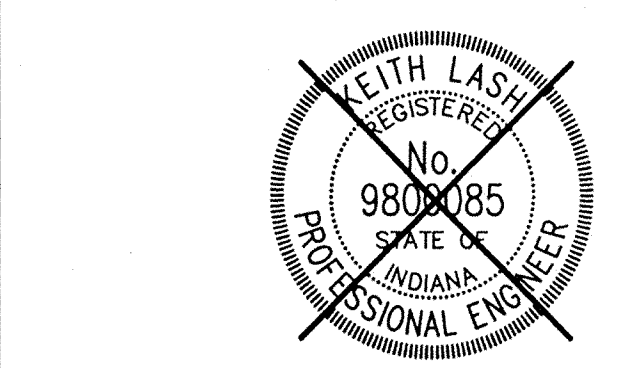

CERTIFIED BY _____

THIS DRAWING AND THE IDEAS, DESIGNS AND CONCEPTS CONTAINED HEREIN ARE THE EXCLUSIVE INTELLECTUAL PROPERTY OF THE SCHNEIDER CORPORATION AND ARE NOT TO BE USED OR REPRODUCED IN WHOLE OR IN PART, WITHOUT THE WRITTEN CONSENT OF THE SCHNEIDER CORPORATION.

1999, The Schneider Corporation

The Schneider Corporation

12726 Hamilton Crossing Blvd. Engineering
 Carmel, Indiana 46032 Surveying
 46032 Landscape Architecture
 317-574-3797 GIS + LIS
 317-574-3799 Fax FEB 18 2000 Geology

OFFICE OF HAMILTON COUNTY SURVEYING
 Formerly Schneider Engineering Corp. / Bohrer, Meyer, Gibson & Assoc.

BRENNICK DEVELOPMENT CO.
 Village of WestClay
 Section 3001

STORM SEWER PLAN

Date	Project No.	Drawn	Apprv.
04/16/99	1238.3001	MG	
Computer Files	Sheet No.		
J:\1238\3001\DWG\C603.DWG XREF: 3001BS.DWG, 3004BS.DWG XREF: MD-BS.DWG, MD-SS-E.DWG XREF: SOU-BS.DWG, STORM.DWG XREF: 750BS.DWG	C603		

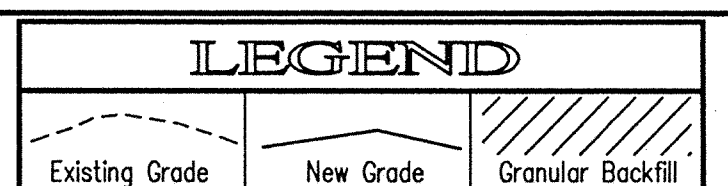

SCALE: HORZ.: 1"=50'
 VERT.: 1"=5'

STORM SEWER PROFILE

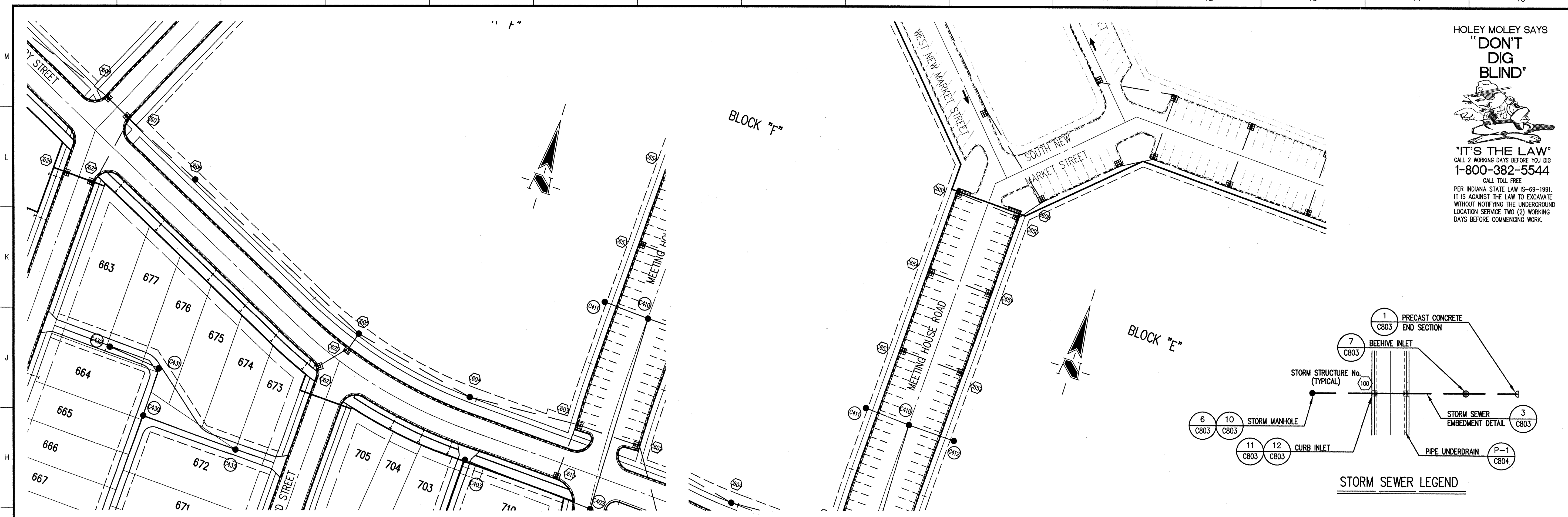

HOLEY MOLEY SAYS
"DON'T DIG BLIND"

"IT'S THE LAW"
 CALL 2 WORKING DAYS BEFORE YOU DIG
 1-800-382-5544
 CALL TOLL FREE
 PER INDIANA STATE LAW IS-69-1991,
 IT IS AGAINST THE LAW TO EXCAVATE
 WITHOUT NOTIFYING THE UNDERGROUND
 LOCATION SERVICE TWO (2) WORKING
 DAYS BEFORE COMMENCING WORK.

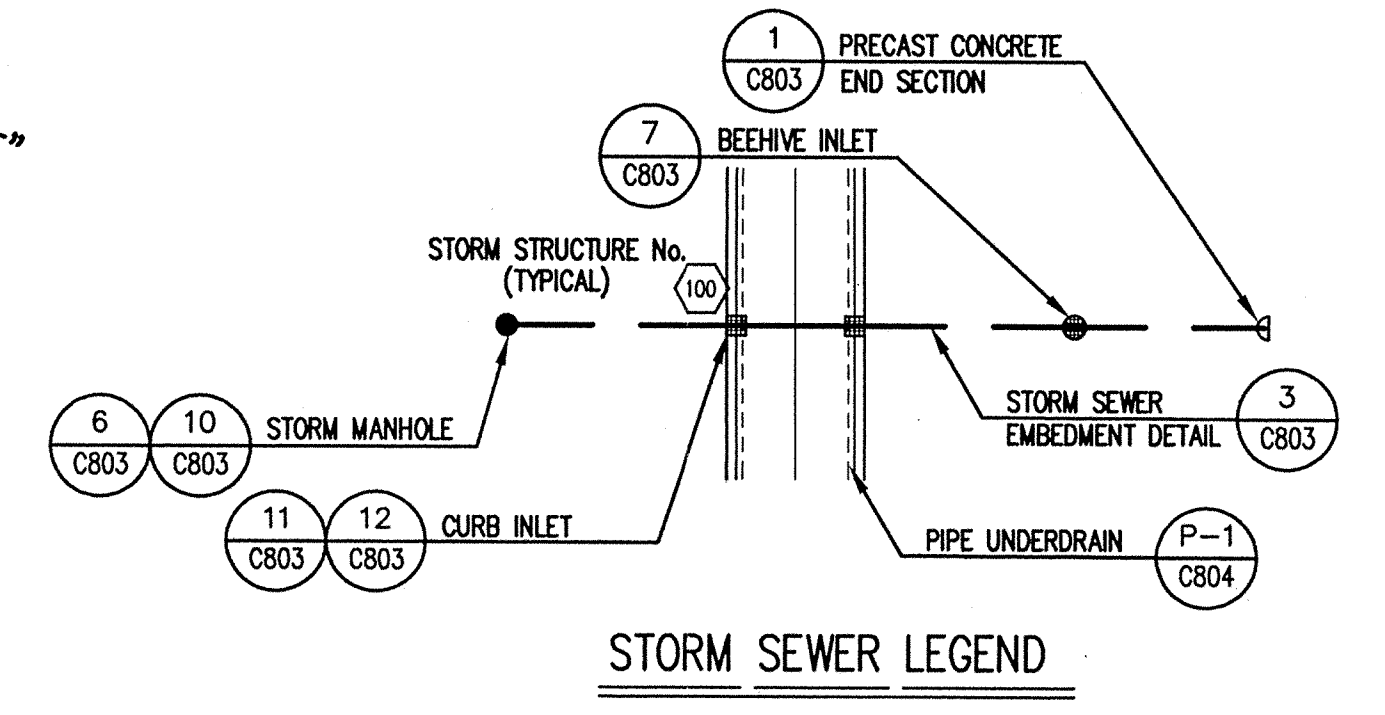

GENERAL NOTES

- TEMPORARY TRAFFIC CONTROL DURING CONSTRUCTION TO CONFORM TO APPLICABLE LOCAL AND STATE STANDARDS.
- ALL CONSTRUCTION ACTIVITY ON THIS SITE TO BE PERFORMED IN COMPLIANCE WITH APPLICABLE O.S.H.A. STANDARDS FOR WORKER SAFETY.
- IT SHALL BE THE CONTRACTORS RESPONSIBILITY TO FIELD VERIFY ALL UTILITY LOCATIONS BEFORE CONSTRUCTION BEGINS.
- CONTRACTORS SHALL MINIMIZE DAMAGE TO EXISTING TREES.

BENCHMARK

TBM #44
 USGS BENCHMARK
 CUT "X" NORTH BONNET BOLT IN FIRE HYDRANT
 EAST SIDE HOOVER RD. ±100' SOUTH OF CLARIDGE
 FARM ENTRANCE.
 ELEVATION - 893.39

Revisions

- DCC 5/10/99, EDITED LEGEND
- 07/19/99, DCC, REVISED GRADING TO ACHIEVE EARTHWORK BALANCE.
- BET, 12/16/99, "RECORD DRAWING"

STORM SEWER PLAN

SCALE: 1"=50'

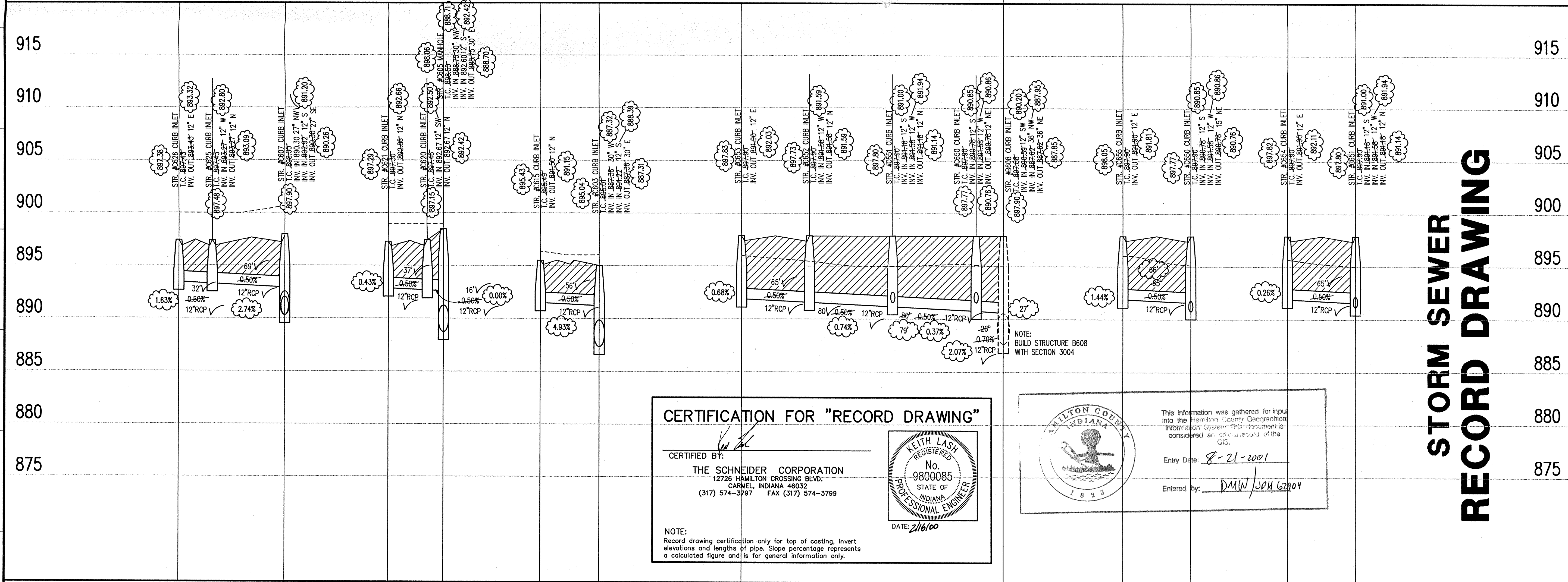

STORM SEWER RECORD DRAWING

CERTIFICATION FOR "RECORD DRAWING"

CERTIFIED BY:

THE SCHNEIDER CORPORATION
 12726 HAMILTON CROSSING BLVD.
 CARMEL, INDIANA 46032
 (317) 574-3797 FAX (317) 574-3799

NOTE:
 Record drawing certification only for top of casting, invert elevations and lengths of pipe. Slope percentage represents a calculated figure and is for general information only.

This information was gathered for input into the Hamilton County Geographic Information System. This information is considered an official record of the GIC.

Entry Date: 8-21-2001
 Entered by: DMW/JDH 6/29/04

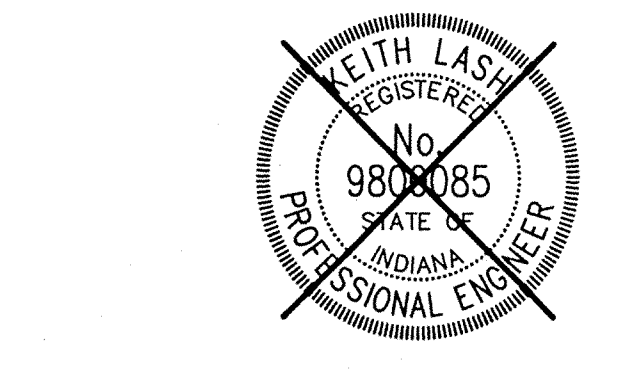

CERTIFIED BY: _____

THIS DRAWING AND THE IDEAS, DESIGNS AND CONCEPTS CONTAINED HEREIN ARE THE EXCLUSIVE INTELLECTUAL PROPERTY OF THE SCHNEIDER CORPORATION AND ARE NOT TO BE USED OR REPRODUCED IN WHOLE OR IN PART, WITHOUT THE WRITTEN CONSENT OF THE SCHNEIDER CORPORATION.

1999, The Schneider Corporation

12726 Hamilton Crossing Blvd. Engineering
 Carmel, Indiana 46032
 317-574-3797
 317-574-3799

LANDSCAPE ARCHITECTURE
 CIVIL & LIS
 GEOLOGY

OFFICE OF HAMILTON COUNTY SURVEYOR
 Formerly Schneider Engineering Corp. / Surveyor Meyer, Gibson & Assoc.

BRUNWICK DEVELOPMENT CO.
 Village of WestClay
 Section 3001

STORM SEWER PLAN

Date	Project No.	Drawn	Apprv.
04/16/99	1238.3001	MG	

LEGEND

Existing Grade	New Grade	Granular Backfill

SCALE: HORZ.: 1"=50'
 VERT.: 1"=5'

Computer Files
 J:\1238\3001\DWG\C604.DWG
 XREF: 300\B5.DWG, 300\B5.DWG
 XREF: M0-B5.DWG, M0-B5-E.DWG
 XREF: S0U-B5.DWG, STORM.DWG

Sheet No.
C604

1:228\3001\DWG\C604.dwg Thu Feb 10 11:40:02 2000

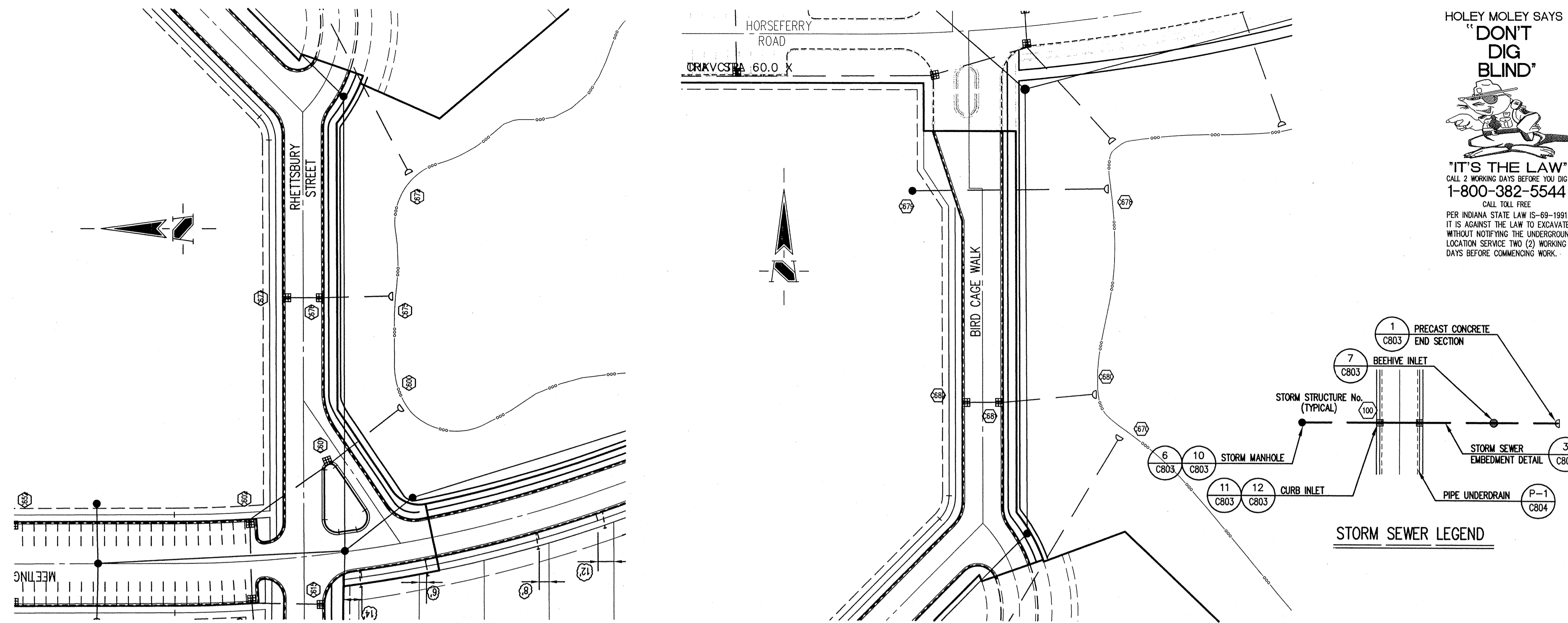

HOLEY MOLEY SAYS
"DON'T DIG BLIND"

"IT'S THE LAW"
 CALL 2 WORKING DAYS BEFORE YOU DIG
1-800-382-5544
 CALL TOLL FREE
 PER INDIANA STATE LAW IS-69-1991,
 IT IS AGAINST THE LAW TO EXCAVATE
 WITHOUT NOTIFYING THE UNDERGROUND
 LOCATION SERVICE TWO (2) WORKING
 DAYS BEFORE COMMENCING WORK.

GENERAL NOTES

1. TEMPORARY TRAFFIC CONTROL DURING CONSTRUCTION TO CONFORM TO APPLICABLE LOCAL AND STATE STANDARDS.
2. ALL CONSTRUCTION ACTIVITY ON THIS SITE TO BE PERFORMED IN COMPLIANCE WITH APPLICABLE O.S.H.A. STANDARDS FOR WORKER SAFETY.
3. IT SHALL BE THE CONTRACTORS RESPONSIBILITY TO FIELD VERIFY ALL UTILITY LOCATIONS BEFORE CONSTRUCTION BEGINS.
4. CONTRACTORS SHALL MINIMIZE DAMAGE TO EXISTING TREES.

BENCHMARK

TBM #44
 USGS BENCHMARK
 CUT "X" NORTH BONNET BOLT IN FIRE HYDRANT
 EAST SIDE HOOVER RD. ±100' SOUTH OF CLARIDGE
 FARM ENTRANCE.
 ELEVATION = 893.39

- Revisions**
1. DCC 5/10/99; EDITED LEGEND
 2. BET, 06/24/99; REVISED STORM SEWERS AND POND GEOMETRY.
 3. 07/19/99; DCC; REVISED GRADING TO ACHIEVE EARTHWORK BALANCE.
 4. BET, 12/16/99; "RECORD DRAWING"

STORM SEWER PLAN

SCALE: 1"=50'

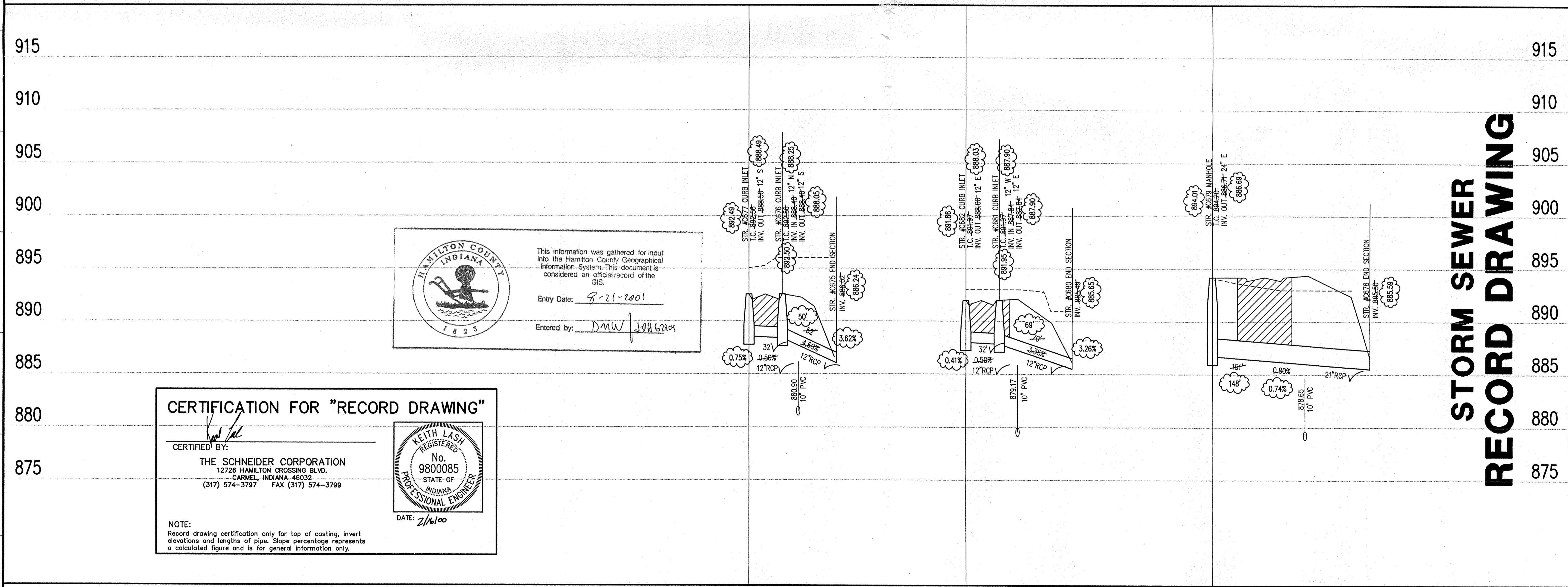

STORM SEWER RECORD DRAWING

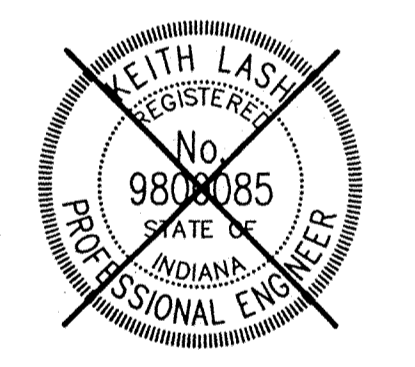

CERTIFIED BY: _____
 THIS DRAWING AND THE IDEAS, DESIGNS AND CONCEPTS CONTAINED HEREIN ARE THE EXCLUSIVE INTELLECTUAL PROPERTY OF THE SCHNEIDER CORPORATION AND ARE NOT TO BE USED OR REPRODUCED IN WHOLE OR IN PART, WITHOUT THE WRITTEN CONSENT OF THE SCHNEIDER CORPORATION.
 1999, The Schneider Corporation

The Schneider Corporation
 12726 Hamilton Crossing Blvd
 Carmel, Indiana 46032
 317-574-3797
 317-574-3799
 Engineering
 Surveying
 Architecture
 GIS • LIS
 Geology
 Formerly Schneider Engineering Corp. • Halden, Meyer, Gibson & Assoc.

BRENNICK DEVELOPMENT CO.
 Village of WestClay
 Section 3001
STORM SEWER PLAN

Date	Project No.	Drawn	Approv.
04/16/99	1238.3001	MC	

Computer Files
 4: V23813001\DWG\5\CS05.DWG
 XREF: 3001BS.DWG, 3004BS.DWG
 XREF: 5001BS.DWG, MD-BS-E.DWG
 XREF: STORM.DWG, HARRISON.DWG

Sheet No.
C605

STORM SEWER PROFILE

LEGEND

	Existing Grade
	New Grade
	Granular Backfill

SCALE: HORZ.: 1"=50'
 VERT.: 1"=5'